

**NOTICE!!**

**These documents have been scanned!**

**Do not place un-scanned documents beneath this notice!**

**Do not remove this notice from this file!**

GPO Jacket No. 560-102  
Print Order 61540  
Rise Business Services, LLC  
Job=AZ15 5/1/2019



Box Number= AZ15013



Claim Begin-End: AMC440214-AMC440222

1 Initial Receipt



AZ15013-6

AMC440098-AMC440515





**United States Department of the Interior**  
**Bureau of Land Management**  
 DIV OF LANDS, MINRLS & ENERGY  
 ONE N CENTRAL AVE  
 PHOENIX, AZ 85004 -4427  
 Phone: 602-417-9200

Receipt

No: 3699349

<b>Transaction #:</b> 3804083	
<b>Date of Transaction:</b> 11/16/2016	
CUSTOMER:	
DWL PROPERTIES LLC 1209 E COUNTY ROAD 16 E LOVELAND, CO 80537-8780 US	

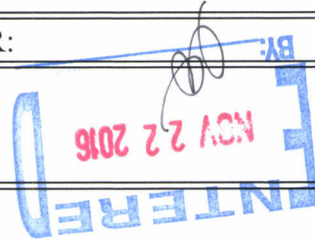

LINE #	QTY	DESCRIPTION	REMARKS	UNIT PRICE	TOTAL
1	9.00	LOCATABLE MINERALS / MINING CLAIMS-NEW, UNADJUD, ONE OR MORE AUTH NOS / NEW MINING CLAIMS LOCATION FEE <b>CASES:</b> AMC440214/\$37.00, AMC440215/\$37.00, AMC440216/\$37.00, AMC440217/\$37.00, AMC440218/\$37.00, AMC440219/\$37.00, AMC440220/\$37.00, AMC440221/\$37.00, AMC440222/\$37.00		- n/a -	333.00
2	9.00	LOCATABLE MINERALS / MINING CLAIMS-NEW, UNADJUD, ONE OR MORE AUTH NOS / NEW MINING CLAIM PROCESSING FEE <b>CASES:</b> AMC440214/\$20.00, AMC440215/\$20.00, AMC440216/\$20.00, AMC440217/\$20.00, AMC440218/\$20.00, AMC440219/\$20.00, AMC440220/\$20.00, AMC440221/\$20.00, AMC440222/\$20.00		- n/a -	180.00
3	9.00	LOCATABLE MINERALS / MINING CLAIMS-NEW, UNADJUD, ONE OR MORE AUTH NOS / NEW MINING CLAIMS MAINTENANCE FEE <b>CASES:</b> AMC440214/\$155.00, AMC440215/\$155.00, AMC440216/\$155.00, AMC440217/\$155.00, AMC440218/\$155.00, AMC440219/\$155.00, AMC440220/\$155.00, AMC440221/\$155.00, AMC440222/\$155.00		- n/a -	1395.00
<b>TOTAL:</b>					<b>\$1,908.00</b>

PAYMENT INFORMATION					
1	AMOUNT:	1908.00	POSTMARKED:	11/10/2016	
	TYPE:	CHECK	RECEIVED:	11/15/2016	

CHECK NO:	2835
NAME:	SILICA LLC PO BOX 1507 CONGRESS AZ 85332 US

REMARKS

This receipt was generated by the automated BLM Collections and Billing System and is a paper representation of a portion of the official electronic record contained therein.



**NOTICE!!**

**These documents have been scanned!**

**Do not place un-scanned documents beneath this notice!**

**Do not remove this notice from this file!**

GPO Jacket No. 560-102  
Print Order 61540  
Rise Business Services, LLC  
Job=AZ15 5/1/2019



Box Number= AZ15013



Claim Begin-End: AMC440214-AMC440222

2 Correspondence



AZ15013-6

AMC440098-AMC440515



**SENDER: COMPLETE THIS SECTION**

- Complete items 1, 2, and 3.
- Print your name and address on the reverse so that we can return the card to you.
- Attach this card to the back of the mailpiece, or on the front if space permits.

1. Article Addressed to:

DWL PROPERTIES LLC; DAVID LORENZ  
 1209 E COUNTY ROAD 16 E  
 LOVELAND, CO 80537-8780  
 9200 RM AMC440214, AMC436621



9590 9402 2630 6336 1244 93

7017 0190 0000 4056 5447

**COMPLETE THIS SECTION ON DELIVERY**

A. Signature

X

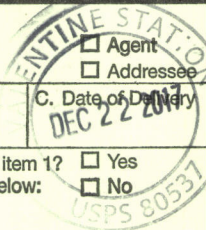

- Agent
- Addressee

B. Received by (Printed Name)

David Lorenz

C. Date of Delivery

DEC 22 2017

- D. Is delivery address different from item 1?  Yes  
 If YES, enter delivery address below:  No

3. Service Type

- Adult Signature
  - Adult Signature Restricted Delivery
  - Certified Mail®
  - Certified Mail Restricted Delivery
  - Collect on Delivery
  - Collect on Delivery Restricted Delivery
  - Priority Mail Express®
  - Registered Mail™
  - Registered Mail Restricted Delivery
  - Return Receipt for Merchandise
  - Signature Confirmation™
  - Signature Confirmation Restricted Delivery
- (over \$500)  
 Mail  
 Mail Restricted Delivery

USPS TRACKING #

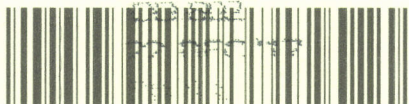

9590 9402 2630 6336 1244 93

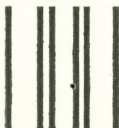

First-Class Mail  
Postage & Fees Paid  
USPS  
Permit No. G-10

United States  
Postal Service

RECEIVED  
BLM AZ STATE OFFICE

2017 DEC 27 A 8:31

PHOENIX ARIZONA

• Sender: Please print your name, address, and ZIP+4® in this box •

U. S. DEPARTMENT OF THE INTERIOR  
BUREAU OF LAND MANAGEMENT  
ARIZONA STATE OFFICE  
ONE NORTH CENTRAL AVENUE, SUITE 800  
PHOENIX, AZ 85004-4427







# United States Department of the Interior

BUREAU OF LAND MANAGEMENT  
Arizona State Office  
One North Central Avenue, Suite 800  
Phoenix, Arizona 85004-4427  
[www.blm.gov/az/](http://www.blm.gov/az/)



DEC 15 2017

In Reply Refer To:  
3830 (9200) RM  
AMC440214, AMC436621

CERTIFIED MAIL - RETURN RECEIPT REQUESTED No. 7017 0190 0000 4056 5447

## DECISION

DWL PROPERTIES LLC; DAVID LORENZ : This decision affects those claims shown  
1209 E COUNTY ROAD 16 E : in the block below.  
LOVELAND, CO 80537-8780 :

---

AMC440217, AMC440219, AMC436623 - AMC436628  
SUNCLOUD #1, SUNCLOUD #3; ASPEN 3 - ASPEN 8

---

## MINING CLAIMS DECLARED FORFEITED

The mining claims listed above have been declared forfeited as of September 1, 2017, for failure to timely file the required maintenance fee payment or small miner's maintenance fee waiver (waiver).

Claimants are required to pay an annual non-refundable maintenance fee of \$155 per 20 acres or portion thereof, or submit a waiver, on or before September 1 of each year. These requirements were established by 30 U.S.C. 28f-1, as amended, and 43 CFR 3834 and 3835.

Our records do not show receipt of a maintenance fee payment or small miner waiver filed on or before the due date. Therefore, the claims listed above are forfeited.

## Reclamation Requirements

This decision does not relieve you of the liability for reclamation of all areas disturbed by your activities on lands covered by the subject mining claim(s) and/or site(s). After you complete the reclamation, you must notify the authorized officer of the appropriate surface managing agency so that the authorized officer may conduct a final site inspection and determine whether you may be released from liability. If you fail to reclaim the land to the satisfaction of the authorized officer, the surface management agency may cite you for noncompliance under its surface management regulations. For land administered by the Bureau of Land Management (BLM), if you fail to

reclaim the land to the satisfaction of the authorized officer as required in 43 CFR Subpart 3809, BLM will issue an order of noncompliance under 43 CFR 3809.601(a). If you fail to comply with the non-compliance order, BLM may take further action under 43 CFR 3809.604. Failure to conduct reclamation is a prohibited act that may subject you to criminal penalties. See 43 CFR 3809.605(h) and 43 CFR 3809.700.

### Appeal Procedures

This decision may be appealed to the Interior Board of Land Appeals, Office of the Secretary, in accordance with the regulations contained in 43 CFR, Part 4, and the enclosed Form 1842-1. If an appeal is taken, your notice of appeal must be filed in this office (at the above address) within 30 days from receipt of this decision. The appellant has the burden of showing that the decision appealed from is in error.

If you wish to file a petition pursuant to regulation 43 CFR 4.21 (58 FR 4939, January 19, 1993) for a stay of the effectiveness of this decision during the time that your appeal is being reviewed by the Board, the petition for a stay must accompany your notice of appeal. A petition for a stay is required to show sufficient justification based on the standards listed below. Copies of the notice of appeal and petition for a stay **must** also be submitted to each party named in this decision and to the Interior Board of Land Appeals and to the appropriate Office of the Solicitor (see 43 CFR 4.413) at the same time the original documents are filed with this office. If you request a stay, you have the burden of proof to demonstrate that a stay should be granted.

### Standards for Obtaining a Stay

Except as otherwise provided by law or other pertinent regulation, a petition for a stay of a decision pending appeal shall show sufficient justification based on the following standards:

- (1) The relative harm to the parties if the stay is granted or denied,
- (2) The likelihood of the appellant's success on the merits,
- (3) The likelihood of immediate and irreparable harm if the stay is not granted, and
- (4) Whether the public interest favors granting the stay.

Please include your AMC serial number(s) on all correspondence. If additional information is required, please call RéAnn Myers at 602-417-9413.



Lucas Lucero  
Deputy State Director  
Lands, Minerals, and Energy Division

Enclosure

**SENDER: COMPLETE THIS SECTION**

- Complete items 1, 2, and 3.
- Print your name and address on the reverse so that we can return the card to you.
- Attach this card to the back of the mailpiece, or on the front if space permits.

1. Article Addressed to:

DWL PROPERTIES LLC  
 1209 E COUNTY ROAD 16 E  
 LOVELAND CO 80537-8780  
 920/RM/AMC440214



9590 9402 2007 6123 0925 69

2. Article Number (Transfer from service label)

7014 2870 0000 1116 2015

**COMPLETE THIS SECTION ON DELIVERY**

A. Signature

X

*[Handwritten Signature]*

 Agent Addressee

B. Received by (Printed Name)

C. Date of Delivery

8-25-17

D. Is delivery address different from item 1?  Yes  
 If YES, enter delivery address below:  No

3. Service Type

- Adult Signature
- Adult Signature Restricted Delivery
- Certified Mail®
- Certified Mail Restricted Delivery
- Collect on Delivery
- Collect on Delivery Restricted Delivery

- Priority Mail Express®
- Registered Mail™
- Registered Mail Restricted Delivery
- Return Receipt for Merchandise
- Signature Confirmation™
- Signature Confirmation Restricted Delivery

Restricted Delivery



USPS TRACKING #

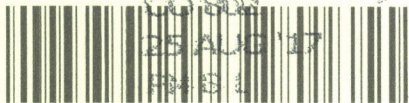

9590 9402 2007 1123 0925 69



First-Class Mail  
Postage & Fees Paid  
USPS  
Permit No. G-10

9590 9402 2007 1123 0925 69

United States  
Postal Service

RECEIVED  
BLM AZ STATE OFFICE

• Sender, please print your name, address, and ZIP+4® in this box •

2017 AUG 30 P 3 01

PHOENIX, ARIZONA

UNITED STATES  
DEPARTMENT OF THE INTERIOR  
Bureau of Land Management  
Arizona State Office  
One N. Central Avenue, Suite 800  
Phoenix, AZ 85004-4427



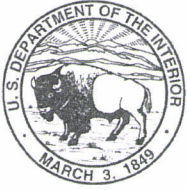

# United States Department of the Interior



BUREAU OF LAND MANAGEMENT

Arizona State Office

One North Central Avenue, Suite 800

Phoenix, Arizona 85004-4427

[www.blm.gov/az/](http://www.blm.gov/az/)

AUG 17 2017

In Reply Refer To:  
3800 (9200) RM  
AMC440214

CERTIFIED MAIL - RETURN RECEIPT REQUESTED No. 7014 2870 0000 1116 2015

## DECISION

DWL PROPERTIES LLC	:	This Decision Affects Those Claims
1209 E COUNTY ROAD 16 E	:	Shown in the Block Below.
LOVELAND, CO 80537-8780	:	

---

AMC440214  
SANDWICH #1

---

### Mining Claim(s) Declared Null and Void

Pursuant to Title 43 Code of Federal Regulations (CFR) 3832.1, this office received your notice(s) of location for recording mining claims. In accordance with 43 CFR 3833.91, the claim(s) listed above is/are hereby declared null and void ab initio for the reason indicated below. A copy of the Master Title Plat is enclosed for your convenience, if applicable.

The date your claim was filed and recorded with the county is prior to the date the claim was located, according to the location notice. You cannot record a claim prior to the date of location.

This decision does not relieve you of the liability for reclamation of all areas disturbed by your activities on land encompassed by your mining claim(s) and/or site(s). After you complete the reclamation, you must notify the authorized officer of the appropriate surface managing agency so that the authorized officer may conduct a final site inspection and determine whether you may be released from liability. If you fail to reclaim the land to the satisfaction of the authorized officer, the surface management agency may cite you for noncompliance under its surface management regulations.

For land administered by the Bureau of Land Management (BLM), if you fail to reclaim the land to the satisfaction of the authorized officer as required in 43 CFR Subpart 3809, the BLM will issue an order of noncompliance under 43 CFR 3809.601(a). If you fail to comply with the noncompliance order, the BLM may take further action under 43 CFR 3809.604. Failure to conduct reclamation is a prohibited act that may subject you to criminal penalties. See 43 CFR 3809.605(h) and 43 CFR 3809.700. If your occupancy has been terminated and you fail to remove structures, material, and equipment, and any personal property in accordance with the regulations in 43 CFR 3715.5-1, the BLM may dispose of the property. In accordance with 43 CFR 3715.5-2, you will remain liable for the costs the BLM incurs in removing and disposing of the property.

### Appeal Procedures

This decision may be appealed to the Interior Board of Land Appeals, Office of the Secretary, in accordance with the regulations contained in 43 CFR, Part 4 and the enclosed Form 1842-1. If an appeal is taken, your notice of appeal must be filed in this office (at the above address) within 30 days from receipt of this decision. The appellant has the burden of showing that the decision appealed from is in error.

If you wish to file a petition pursuant to regulation 43 CFR 4.21 (58 FR 4939, January 19, 1993), for a stay of the effectiveness of this decision during the time that your appeal is being reviewed by the Board, the petition for a stay must accompany your notice of appeal. A petition for a stay is required to show sufficient justification based on the standards listed below. Copies of the notice of appeal and petition for a stay must also be submitted to each party named in this decision and to the Interior Board of Land Appeals and to the appropriate Office of the Solicitor (see 43 CFR 4.413) at the same time the original documents are filed with this office. If you request a stay, you have the burden of proof to demonstrate that a stay should be granted.

### Standards for Obtaining a Stay

Except as otherwise provided by law or other pertinent regulation, a petition for a stay of a decision pending appeal shall show sufficient justification based on the following standards:

- (1) The relative harm to the parties if the stay is granted or denied,
- (2) The likelihood of the appellant's success on the merits,
- (3) The likelihood of immediate and irreparable harm if the stay is not granted, and
- (4) Whether the public interest favors granting the stay.

If additional information is required, please contact RéAnn Myers at 602-417-9413. Please include your AMC serial number(s) on all correspondence.

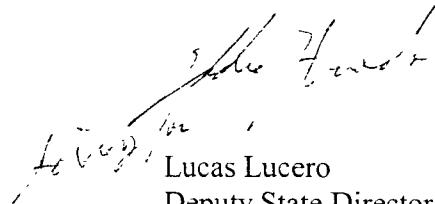

Lucas Lucero  
Deputy State Director  
Lands, Minerals and Energy Division

Enclosure(s)



**NOTICE!!**

**These documents have been scanned!**

**Do not place un-scanned documents beneath this notice!**

**Do not remove this notice from this file!**

GPO Jacket No. 560-102  
Print Order 61540  
Rise Business Services, LLC  
Job=AZ15 5/1/2019



Box Number= AZ15013



Claim Begin-End: AMC440214-AMC440222

3 Transfers



AZ15013-6

AMC440098-AMC440515

**NO  
DOCUMENTS  
FOUND**

NO DOCUMENTS FOUND  
NO DOCUMENTS FOUND



**NOTICE!!**

**These documents have been scanned!**

**Do not place un-scanned documents beneath this notice!**

**Do not remove this notice from this file!**

GPO Jacket No. 560-102  
Print Order 61540  
Rise Business Services, LLC  
Job=AZ15 5/1/2019



Box Number= AZ15013



Claim Begin-End: AMC440214-AMC440222

4 Annual Filings



AZ15013-6

AMC440098-AMC440515



DEPARTMENT OF THE INTERIOR  
BUREAU OF LAND MANAGEMENT  
MINING CLAIMS

Run Date/Time: 9/11/2018

MC Maintenance Fees Paid Through the BLM Pay Portal  
(by Date Paid)

Page 393 Of 723

**CBS Receipt: 4248146**

Printed For Lead File # AMC440214

Agency Tracking ID: 1535490088

Assessment Year: 2019

Number of BLM Serial Nr: 12

Paid On: 8/28/2018

Total Amount Paid: \$1,860.00

Claim Name	BLM Serial No	Lead File No	Amount Paid
FUTURE #1	AMC438028	AMC438028	\$155.00
SANDWICH #2	AMC440215	AMC440214	\$155.00
SANDWICH #3	AMC440216	AMC440214	\$155.00
SUNCLOUD #2	AMC440218	AMC440214	\$155.00
SUNCLOUD #4	AMC440220	AMC440214	\$155.00
SUNCLOUD #5	AMC440221	AMC440214	\$155.00
SUNCLOUD #6	AMC440222	AMC440214	\$155.00
SANDWITCH 1	AMC445883	AMC445883	\$155.00
BLIND INDIAN 1	AMC448323	AMC448323	\$155.00
BLIND INDIAN 2	AMC448324	AMC448323	\$155.00
BLIND INDIAN 3	AMC448325	AMC448323	\$155.00
BLIND INDIAN 4	AMC448326	AMC448323	\$155.00

**United States Department of the Interior**  
**Bureau of Land Management**  
 BUSINESS & SUPPORT SVCS DIV  
 ONE N CENTRAL AVE SUITE 800  
 PHOENIX, AZ 85004 -4427  
 Phone: 602-417-9200

Receipt

No: 4248146

<b>Transaction #:</b> 4363620	
<b>Date of Transaction:</b> 08/28/2018	
<b>CUSTOMER:</b>	
DAVID LORENZ 1209 ECR 16E LOVELAND, CO 80537 US	

LINE #	QTY	DESCRIPTION	REMARKS	UNIT PRICE	TOTAL
1	1.00	LOCATABLE MINERALS / MINING CLAIMS- NOT NEW-UNADJUD, ONE AUTH NO. ONLY / MINING CLAIM MONEY RECEIVED CASES: AMC448324/\$1860.00		- n/a -	1860.00
<b>TOTAL:</b>					<b>\$1,860.00</b>

PAYMENT INFORMATION				
NOTE: Items will appear on credit card statement as "BLM O Mining Claim".				
1	AMOUNT:	1860.00	POSTMARKED:	N/A
	TYPE:	CREDIT CARD	RECEIVED:	08/28/2018
	NAME:	DAVID LORENZ 1209 ECR 16E LOVELAND CO 80537 US		
	CARD NO:	XXXXXXXXXXXX3034	AUTH CODE:	06892D
	NAME ON CARD:	DAVID LORENZ		
	SIGNATURE:			

REMARKS

This receipt was generated by the automated BLM Collections and Billing System and is a paper representation of a portion of the official electronic record contained therein.

DEPARTMENT OF THE INTERIOR  
BUREAU OF LAND MANAGEMENT  
MINING CLAIMS

MC Maintenance Fees Paid Through the BLM Pay Portal

CBS Receipt: 3968441

Printed For Lead File # AMC440214

Agency Tracking ID: 1504216627

Number of BLM Serial Nr: 11

Assessment Year: 2018

Paid On: 08/31/2017

Total Amount Paid: \$1,705.00

Claim Name	BLM Serial No	Lead File No	Amount Paid
FUTURE #1	AMC438028	AMC438028	\$155.00
FUTURE #2	AMC438458	AMC438458	\$155.00
4 QUEENS #1	AMC438505	AMC438505	\$155.00
TIGER #2	AMC438795	AMC438795	\$155.00
ARASTA #1	AMC438871	AMC438871	\$155.00
SANDWICH #2	AMC440215	AMC440214	\$155.00
SANDWICH #3	AMC440216	AMC440214	\$155.00
SUNCLOUD #2	AMC440218	AMC440214	\$155.00
SUNCLOUD #4	AMC440220	AMC440214	\$155.00
SUNCLOUD #5	AMC440221	AMC440214	\$155.00
SUNCLOUD #6	AMC440222	AMC440214	\$155.00



**United States Department of the Interior**  
**Bureau of Land Management**  
 BUSINESS & SUPPORT SVCS DIV  
 ONE N CENTRAL AVE SUITE 800  
 PHOENIX, AZ 85004 -4427  
 Phone: 602-417-9200

Receipt

No: 3968441

5

<b>Transaction #:</b> 4078338	
<b>Date of Transaction:</b> 08/31/2017	
<b>CUSTOMER:</b>	
AMY SCHMIDT 1209 E CNTY RD 16E LOVELAND, CO 80537 US	

LINE #	QTY	DESCRIPTION	REMARKS	UNIT PRICE	TOTAL
1	1.00	LOCATABLE MINERALS / MINING CLAIMS- NOT NEW-UNADJUD, ONE AUTH NO. ONLY / MINING CLAIM MONEY RECEIVED CASES: AMC438871/\$1705.00		- n/a -	1705.00
<b>TOTAL:</b>					<b>\$1,705.00</b>

PAYMENT INFORMATION					
NOTE: Items will appear on credit card statement as "BLM O Mining Claim".					
1	AMOUNT:	1705.00	POSTMARKED:	N/A	
	TYPE:	CREDIT CARD	RECEIVED:	08/31/2017	
	NAME:	AMY SCHMIDT 1209 E CNTY RD 16E LOVELAND CO 80537 US			
	CARD NO:	XXXXXXXXXXXX3034	AUTH CODE:	05216D	
	NAME ON CARD:	AMY SCHMIDT			
	EXPIRES:	11/2019			
	SIGNATURE:				

REMARKS

This receipt was generated by the automated BLM Collections and Billing System and is a paper representation of a portion of the official electronic record contained therein.

December 15, 2016

BLM, Arizona State Office  
One North Central Ave Ste 800  
Phoenix, AZ 85004

Reg: Notice of Intent to Hold

Please find enclosed Notices of Intent to Hold form MCF110 for 32 claims in Arizona and check number 1019 for \$320.00 for filing of claims. Once filed please return to:

DWL Properties LLC  
1209 E Cnty Rd 16E  
Loveland, CO 80537

Thank You

David Lorenz  
928-232-2173

415416  
415905  
436621  
438028  
438458  
438467  
438505  
438795  
438871  
440214

RECEIVED  
BLM ARIZONA  
2016 DEC 22 P 2:52  
PHOENIX, ARIZONA

RECEIVED  
 2016 DEC 22 P 2:52  
 PUEBLO, ARIZONA

**NOTICE OF INTENTION TO HOLD MINING CLAIMS/SITES**

When Recorded Return Document to:

DWL Properties LLC  
1219 E City Rd WGE  
Loveland CO 80537

BLM  
Date  
Stamp

Check here if this is a change of address.

Telephone: \_\_\_\_\_

E-mail Address: dave.lorenzlo@gmail.com

I (We) intend to hold the claims(s) and/or site(s) listed below for the calendar year 2016, and I (We) have filed or will file a Notice of Intent to Hold in the county where the claim (s) is located.

Reason for filing a Notice of Intent to Hold instead of an assessment work filing (check one):

- Maintenance fee was paid to maintain claim(s) during this assessment year.
- Mill or tunnel sites.
- Claim(s) was located during the current assessment year.
- BLM has deferred assessment work (attach copy of decision granting deferment, or pending petition for deferment including date petition was filed.)

Line No.	AMC NUMBER	CLAIM/SITE NAME	COUNTY RECORDER DATA (If available)	TWP	RNG	SEC
1	438467	Blind Indian #1		11 N	2 W	33
2	438468	Blind Indian #2		11 N	2 W	33
3	438469	Blind Indian #3		11 N	2 W	33/32
4	438470	Blind Indian #4		11 N	2 W	32
5	440214	Sandwich #1	2016-0054481	13 N	10 W	4
6	440215	Sandwich #2	2016-0054482	13 N	10 W	4
7	440216	Sandwich #3	2016-0054483	13 N	10 W	4
8	440217	Suncloud #1	2016-0054475	13 N	10 W	9
9	440218	Suncloud #2	2016-0054476	13 N	10 W	9
10	440219	Suncloud #3	2016-0054477	13 N	10 W	9



NOTICE OF INTENTION TO HOLD MINING CLAIMS/SITES  
page 2

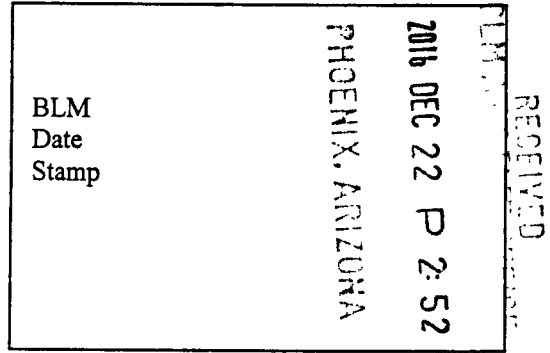

1. State of Arizona, County of Yavapai

2. I (Name) David W. Arvanz

3. Reside at (Address) 18387 S Weaver Mesa Rd

City Peoples Valley County Yavapai State AZ Zip 86332 being duly sworn, depose and say that I am a citizen of the United States, more than eighteen years of age, that all of the facts set forth in this notice, subject to the provisions and penalties of 18 U.S.C. 1001 pertaining to the filing of false, fictitious, or fraudulent statements with the United States, are true and correct according to the best of my knowledge, information and belief.

4. Owner's name and address (If not shown in Items 1-3 above). \_\_\_\_\_

5. Dated: 12/15/16 Signature: [Signature]

Bureau of Land Management  
Arizona State Office  
[www.blm.gov/az](http://www.blm.gov/az)

No. of Claims:	<u>10</u>	x \$10 =	<u>\$100.00</u>
Check No:	<u>1019</u>	Init.	<u>[Initials]</u>
Receipt No.:	<u>3778404</u>		
For BLM Use Only			

RECEIVED  
 2016 DEC 22 P 2:52  
 PHOENIX, ARIZONA

**NOTICE OF INTENTION TO HOLD MINING CLAIMS/SITES**

When Recorded Return Document to:

Dave Topertus LLC  
1209 E. Pinta Rd  
Loveland, CO 80537

BLM  
 Date  
 Stamp

Check here if this is a change of address.

Telephone: \_\_\_\_\_

E-mail Address: dave.topertus@gmail.com

I (We) intend to hold the claims(s) and/or site(s) listed below for the calendar year 2016, and I (We) have filed or will file a Notice of Intent to Hold in the county where the claim (s) is located.

Reason for filing a Notice of Intent to Hold instead of an assessment work filing (check one):

- Maintenance fee was paid to maintain claim(s) during this assessment year.
- Mill or tunnel sites.
- Claim(s) was located during the current assessment year.
- BLM has deferred assessment work (attach copy of decision granting deferment, or pending petition for deferment including date petition was filed.)

Line No.	AMC NUMBER	CLAIM/SITE NAME	COUNTY RECORDER DATA (If available)	TWP	RNG	SEC
1	440220	Suncloid #4	2016-0054478	13N	10W	9
2	440221	Suncloid #5	2016-0054479	13N	10W	9
3	440222	Suncloid #6	2016-0054480	13N	10W	9
4	436621	Aspen #1	2016-003668	13N	10W	14
5	436622	Aspen #2	2016-003669	13N	10W	14
6	436623	Aspen #3	2016-003670	13N	10W	14
7	436624	Aspen #4	2016-003671	13N	10W	14
8	436625	Aspen #5	2016-003672	13N	10W	14
9	436626	Aspen #6	2016-003673	13N	10W	14
10	436627	Aspen #7	2016-003674	10N	10W	8

NOTICE OF INTENTION TO HOLD MINING CLAIMS/SITES  
page 2

BLM  
Date  
Stamp

2016 DEC 22 P 2:52  
PHOENIX, ARIZONA

RECEIVED  
BLM

- 1. State of Arizona, County of Yavapai
- 2. I (Name) David W Lorenz
- 3. Reside at (Address) 18387 S Weaver Mesa Rd

City Peoples Valley County Yavapai State AZ Zip 86332 being duly sworn, depose and say that I am a citizen of the United States, more than eighteen years of age, that all of the facts set forth in this notice, subject to the provisions and penalties of 18 U.S.C. 1001 pertaining to the filing of false, fictitious, or fraudulent statements with the United States, are true and correct according to the best of my knowledge, information and belief.

4. Owner's name and address (If not shown in Items 1-3 above). \_\_\_\_\_

5. Dated: 12/13/16 Signature: [Signature]

Bureau of Land Management  
Arizona State Office  
[www.blm.gov/az](http://www.blm.gov/az)

No. of Claims: 10 x \$10 = \$100-  
Check No: 1019 Init. ASL  
Receipt No.: 3728404  
For BLM Use Only



RECEIVED  
 BLM  
 2016 DEC 22 P 2:53  
 PHOENIX, ARIZONA

**NOTICE OF INTENTION TO HOLD MINING CLAIMS/SITES**

When Recorded Return Document to:

DWL Products LLC  
1209 E. Camel Rd 110E  
Lowland, CO 80537

BLM  
Date  
Stamp

Check here if this is a change of address.

Telephone: \_\_\_\_\_

E-mail Address: dave.lorin@co.comail.com

I (We) intend to hold the claims(s) and/or site(s) listed below for the calendar year 2016, and I (We) have filed or will file a Notice of Intent to Hold in the county where the claim (s) is located.

Reason for filing a Notice of Intent to Hold instead of an assessment work filing (check one):

- Maintenance fee was paid to maintain claim(s) during this assessment year.
- Mill or tunnel sites.
- Claim(s) was located during the current assessment year.
- BLM has deferred assessment work (attach copy of decision granting deferment, or pending petition for deferment including date petition was filed.)

Line No.	AMC NUMBER	CLAIM/SITE NAME	COUNTY RECORDER DATA (If available)	TWP	RNG	SEC
1	436628	Aspen #8	2016-003675	10N	10W	18
2	436629	Aspen #9	2016-003676	10N	10W	7
3						
4						
5						
6						
7						
8						
9						
10						

NOTICE OF INTENTION TO HOLD MINING CLAIMS/SITES  
page 2

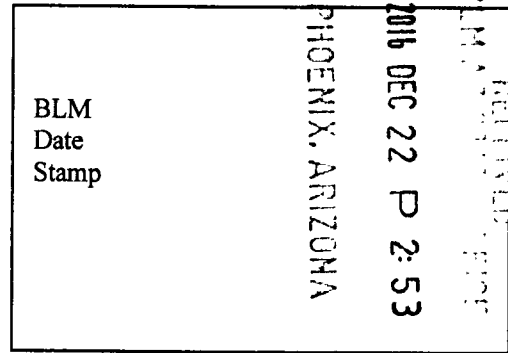

- 1. State of Arizona, County of Yavapai
- 2. I (Name) David W Lorenz
- 3. Reside at (Address) 18327 S Weaver Mtn Rd

City Peeples Valley County Yavapai State AZ Zip 86332 being duly sworn, depose and say that I am a citizen of the United States, more than eighteen years of age, that all of the facts set forth in this notice, subject to the provisions and penalties of 18 U.S.C. 1001 pertaining to the filing of false, fictitious, or fraudulent statements with the United States, are true and correct according to the best of my knowledge, information and belief.

4. Owner's name and address (If not shown in Items 1-3 above). \_\_\_\_\_

5. Dated: 12/15/16 Signature: [Signature]

Bureau of Land Management  
Arizona State Office  
[www.blm.gov/az](http://www.blm.gov/az)

No. of Claims:	<u>2</u>	x \$10 =	<u>\$20.00</u>
Check No:	<u>1019</u>	Init.	<u>DL</u>
Receipt No.:	<u>3728404</u>		
For BLM Use Only			

**NOTICE OF INTENTION TO HOLD MINING CLAIMS/SITES**

When Recorded Return Document to:

Dave Products LLC  
1214 E. McIntire Rd  
Lowland, CO 80537

RECEIVED  
 2016 DEC 22 P 2:53  
 PHOENIX, ARIZONA  
 BLM  
 Date  
 Stamp

Check here if this is a change of address.  
 Telephone: \_\_\_\_\_

E-mail Address: dave.lorenzlo@gmail.com

I (We) intend to hold the claims(s) and/or site(s) listed below for the calendar year 2016, and I (We) have filed or will file a Notice of Intent to Hold in the county where the claim (s) is located.

Reason for filing a Notice of Intent to Hold instead of an assessment work filing (check one):

- Maintenance fee was paid to maintain claim(s) during this assessment year.
- Mill or tunnel sites.
- Claim(s) was located during the current assessment year.
- BLM has deferred assessment work (attach copy of decision granting deferment, or pending petition for deferment including date petition was filed.)

Line No.	AMC NUMBER	CLAIM/SITE NAME	COUNTY RECORDER DATA (If available)	TWP	RNG	SEC
1	438028	Fishve #1	2016-02061	7N	13W	14
2	438458	Fishve #2	2016-01927	7N	13W	14
3	438555	4 Rivers #1	2016-02216	5N	10W	31
4	415408	Black Cat		5N	14W	26
5	415421	Lion King		10N	11W	25
6						
7						
8						
9						
10						

NOTICE OF INTENTION TO HOLD MINING CLAIMS/SITES  
page 2

BLM  
Date  
Stamp

RECEIVED  
2016 DEC 22 P 2 53  
PHOENIX, ARIZONA

1. State of Arizona, County of La Paz

2. I (Name) David W Lounz

3. Reside at (Address) 18377 S Weaver Mesa Rd

City Peoples Valley County Navajo State AZ Zip 86332

being duly sworn, depose and say that I am a citizen of the United States, more than eighteen years of age, that all of the facts set forth in this notice, subject to the provisions and penalties of 18 U.S.C. 1001 pertaining to the filing of false, fictitious, or fraudulent statements with the United States, are true and correct according to the best of my knowledge, information and belief.

4. Owner's name and address (If not shown in Items 1-3 above).

5. Dated: 12/15/16 Signature: [Signature]

Bureau of Land Management  
Arizona State Office  
[www.blm.gov/az](http://www.blm.gov/az)

No. of Claims: 5 x \$10 = \$50.-  
Check No: 1019 Init. DL  
Receipt No.: 3728404  
For BLM Use Only



**NOTICE OF INTENTION TO HOLD MINING CLAIMS/SITES**

When Recorded Return Document to:

Duck Properties  
209 E City Rd 110E  
Lowland AZ 85337

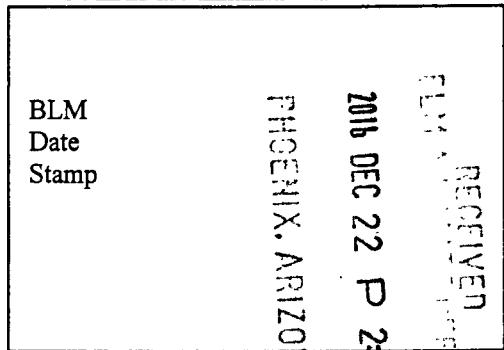

Check here if this is a change of address.

Telephone: \_\_\_\_\_

E-mail Address: dave.lorenz16@gmail.com

I (We) intend to hold the claims(s) and/or site(s) listed below for the calendar year 2016, and I (We) have filed or will file a Notice of Intent to Hold in the county where the claim (s) is located.

Reason for filing a Notice of Intent to Hold instead of an assessment work filing (check one):

- Maintenance fee was paid to maintain claim(s) during this assessment year.
- Mill or tunnel sites.
- Claim(s) was located during the current assessment year.
- BLM has deferred assessment work (attach copy of decision granting deferment, or pending petition for deferment including date petition was filed.)

Line No.	AMC NUMBER	CLAIM/SITE NAME	COUNTY RECORDER DATA (If available)	TWP	RNG	SEC
1	438795	Tiger #2	2016-0448924	5N	9W	27
2	438711	Arasta #1	2016-0461938	5N	9W	23
3						
4						
5						
6						
7						
8						
9						
10						

NOTICE OF INTENTION TO HOLD MINING CLAIMS/SITES  
page 2

BLM  
Date  
Stamp  
RECEIVED  
2016 DEC 22 P 2:53  
PHOENIX, ARIZONA

1. State of Arizona, County of Maricopa

2. I (Name) David W Lorenz

3. Reside at (Address) 18387 Silver Mountain Rd

City Peeples Valley County Yavapai State AZ Zip 86332 being duly sworn, depose and say that I am a citizen of the United States, more than eighteen years of age, that all of the facts set forth in this notice, subject to the provisions and penalties of 18 U.S.C. 1001 pertaining to the filing of false, fictitious, or fraudulent statements with the United States, are true and correct according to the best of my knowledge, information and belief.

4. Owner's name and address (If not shown in Items 1-3 above).

5. Dated: 12/13/16 Signature: [Signature]

Bureau of Land Management  
Arizona State Office  
[www.blm.gov/az](http://www.blm.gov/az)

No. of Claims: 2 x \$10 = \$20.00  
Check No: 1019 Init. [Initials]  
Receipt No.: 3728404  
For BLM Use Only

DWL Properties  
1209 E Cnty Rd 16E  
Loveland, CO 80537

7016 1970 0001 0576 5849

PLACE STICKER AT TOP OF ENVELOPE TO THE RIGHT  
OF THE RETURN ADDRESS, FOLD AT DOTTED LINE

**CERTIFIED MAIL**



7016 1970 0001 0576 5849



1000



85004

U.S. POST  
PAID  
BERTHO  
80513  
DEC 19  
AMOL

**\$4**

R2304W

2016 DEC 22 P 2:52  
PHOENIX, ARIZONA

BLM Arizona State Office  
One N Central Ave  
Ste 800  
Phoenix, AZ 85004

85004-230999

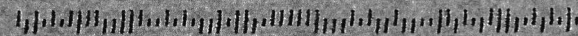

**United States Department of the Interior**  
**Bureau of Land Management**  
 DIV OF LANDS, MINRLS & ENERGY  
 ONE N CENTRAL AVE  
 PHOENIX, AZ 85004 -4427  
 Phone: 602-417-9200

Receipt

No: 3728404

<b>Transaction #:</b> 3833671	
<b>Date of Transaction:</b> 12/23/2016	
CUSTOMER:	
DWL PROPERTIES LLC 1209 E COUNTY ROAD 16 E LOVELAND, CO 80537-8780 US	

LINE #	QTY	DESCRIPTION	REMARKS	UNIT PRICE	TOTAL
1	1.00	LOCATABLE MINERALS / MINING CLAIMS- NOT NEW-UNADJUD, ONE AUTH NO. ONLY / MINING CLAIM MONEY RECEIVED CASES: AMC438467/\$320.00	NOI (32) 2016	- n/a -	320.00
<b>TOTAL:</b>					<b>\$320.00</b>

PAYMENT INFORMATION					
1	AMOUNT:	320.00	POSTMARKED:	12/20/2016	
	TYPE:	CHECK	RECEIVED:	12/22/2016	
	CHECK NO:	1019			
	NAME:	DWL PROPERTIES LLC 1209 E COUNTY ROAD 16 E LOVELAND CO 80537-8780 US			

REMARKS

This receipt was generated by the automated BLM Collections and Billing System and is a paper representation of a portion of the official electronic record contained therein.

**ENTERED**  
 DEC 27 2016  



**DEPARTMENT OF THE INTERIOR  
BUREAU OF LAND MANAGEMENT  
MINING CLAIMS**

**MC Customer Information - With Serial No. and Claim Name  
ACTIVE CLAIMS**

Admin State: AZ

Geo State: AZ

LORENZ DAVID  
1209 E COUNTY ROAD 16 E  
LOVELAND, CO 80537-8780

CUSTOMER ID: 2333956

<u>Serial No.</u>	<u>Claim Name/Number</u>	<u>Lead Serial No.</u>	<u>Disposition</u>
AMC414493	CACTUS QUEEN	AMC414489	ACTIVE
AMC414499	JEFFERSON	AMC414489	ACTIVE
AMC414501	LITTLE KIMBLE	AMC414489	ACTIVE
✓AMC415421	LION KING	AMC415416	ACTIVE
✓AMC415908	BLACK CAT	AMC415905	ACTIVE
✓AMC436621	ASPEN 1	AMC436621	ACTIVE
✓AMC436622	ASPEN 2	AMC436621	ACTIVE
✓AMC436623	ASPEN 3	AMC436621	ACTIVE
✓AMC436624	ASPEN 4	AMC436621	ACTIVE
✓AMC436625	ASPEN 5	AMC436621	ACTIVE
✓AMC436626	ASPEN 6	AMC436621	ACTIVE
✓AMC436627	ASPEN 7	AMC436621	ACTIVE
✓AMC436628	ASPEN 8	AMC436621	ACTIVE
✓AMC436629	ASPEN 9	AMC436621	ACTIVE

Number of ACTIVE cases: 14

**DEPARTMENT OF THE INTERIOR  
BUREAU OF LAND MANAGEMENT  
MINING CLAIMS**

**MC Customer Information - With Serial No. and Claim Name  
ACTIVE CLAIMS**

Admin State: AZ

Geo State: AZ

**DWL PROPERTIES AZ LLC  
18387 S WEAVER MOUNTAIN RD  
PEEPLER VALLEY, AZ 86332-8655**

CUSTOMER ID: 2398625

<u>Serial No.</u>	<u>Claim Name/Number</u>	<u>Lead Serial No.</u>	<u>Disposition</u>
✓AMC438458	FUTURE #2	AMC438458	ACTIVE
✓AMC438505	4 QUEENS #1	AMC438505	ACTIVE
✓AMC438795	TIGER #2	AMC438795	ACTIVE
✓AMC438871	ARASTA #1	AMC438871	ACTIVE

Number of ACTIVE cases: 4

**DWL PROPERTIES LLC  
1209 E COUNTY ROAD 16 E  
LOVELAND, CO 80537-8780**

CUSTOMER ID: 2399249

<u>Serial No.</u>	<u>Claim Name/Number</u>	<u>Lead Serial No.</u>	<u>Disposition</u>
✓AMC438028	FUTURE #1	AMC438028	ACTIVE
✓AMC438467	BLIND INDIAN #1	AMC438467	ACTIVE
✓AMC438468	BLIND INDIAN #2	AMC438467	ACTIVE
✓AMC438469	BLIND INDIAN #3	AMC438467	ACTIVE
✓AMC438470	BLIND INDIAN #4	AMC438467	ACTIVE
✓AMC440214	SANDWICH #1	AMC440214	ACTIVE
✓AMC440215	SANDWICH #2	AMC440214	ACTIVE
✓AMC440216	SANDWICH #3	AMC440214	ACTIVE
✓AMC440217	SUNCLOUD #1	AMC440214	ACTIVE
✓AMC440218	SUNCLOUD #2	AMC440214	ACTIVE
✓AMC440219	SUNCLOUD #3	AMC440214	ACTIVE
✓AMC440220	SUNCLOUD #4	AMC440214	ACTIVE
✓AMC440221	SUNCLOUD #5	AMC440214	ACTIVE
✓AMC440222	SUNCLOUD #6	AMC440214	ACTIVE

Number of ACTIVE cases: 14

**DEPARTMENT OF THE INTERIOR**  
**BUREAU OF LAND MANAGEMENT**  
**MINING CLAIMS**

**MC Customer Information - With Serial No. and Last Assessment Code**  
**ACTIVE CLAIMS**

Admin State: AZ

Geo State: AZ

DWL PROPERTIES LLC  
 1209 E COUNTY ROAD 16 E  
 LOVELAND, CO 80537-8780

CUSTOMER ID: 2399249

<u>Serial No.</u>	<u>Claim Name/Number</u>	<u>Last Assmt Code</u>	<u>Last Assmt YR</u>	<u>Disposition</u>
AMC438028	FUTURE #1	782	2017	ACTIVE
AMC438467	BLIND INDIAN #1	782	2017	ACTIVE
AMC438468	BLIND INDIAN #2	782	2017	ACTIVE
AMC438469	BLIND INDIAN #3	782	2017	ACTIVE
AMC438470	BLIND INDIAN #4	782	2017	ACTIVE
AMC440214	SANDWICH #1	484	2017	ACTIVE
AMC440215	SANDWICH #2	484	2017	ACTIVE
AMC440216	SANDWICH #3	484	2017	ACTIVE
AMC440217	SUNCLOUD #1	484	2017	ACTIVE
AMC440218	SUNCLOUD #2	484	2017	ACTIVE
AMC440219	SUNCLOUD #3	484	2017	ACTIVE
AMC440220	SUNCLOUD #4	484	2017	ACTIVE
AMC440221	SUNCLOUD #5	484	2017	ACTIVE
AMC440222	SUNCLOUD #6	484	2017	ACTIVE

Number of ACTIVE cases: 14



**DEPARTMENT OF THE INTERIOR  
BUREAU OF LAND MANAGEMEN  
MINING CLAIMS**

**MC Customer Information - With Serial No. and Last Assessment Code  
ACTIVE CLAIMS**

Admin State: AZ

Geo State: AZ

**LORENZ DAVID  
1209 E COUNTY ROAD 16 E  
LOVELAND, CO 80537-8780**

CUSTOMER ID: 2333956

<u>Serial No.</u>	<u>Claim Name/Number</u>	<u>Last Assmt Code</u>	<u>Last Assmt YR</u>	<u>Disposition</u>
AMC414493	CACTUS QUEEN	782	2017	ACTIVE
AMC414499	JEFFERSON	782	2017	ACTIVE
AMC414501	LITTLE KIMBLE	782	2017	ACTIVE
AMC415421	LION KING	782	2017	ACTIVE
AMC415908	BLACK CAT	782	2017	ACTIVE
AMC436621	ASPEN 1	782	2017	ACTIVE
AMC436622	ASPEN 2	782	2017	ACTIVE
AMC436623	ASPEN 3	782	2017	ACTIVE
AMC436624	ASPEN 4	782	2017	ACTIVE
AMC436625	ASPEN 5	782	2017	ACTIVE
AMC436626	ASPEN 6	782	2017	ACTIVE
AMC436627	ASPEN 7	782	2017	ACTIVE
AMC436628	ASPEN 8	782	2017	ACTIVE
AMC436629	ASPEN 9	782	2017	ACTIVE

Number of ACTIVE cases: 14

**Authorized Date**01/23/2017

**Instructions to Accounts**AZ BLM REFUND TO DWL PROPERTIES LLC \$30.00 FOR  
OVERPAYMENT ON AMC438467 RECEIPT #3728404. IO

**Login ID**7196

**Entry Date**01/23/2017

**Total Amount**\$30.00

**NOTICE!!**

**These documents have been scanned!**

**Do not place un-scanned documents beneath this notice!**

**Do not remove this notice from this file!**

GPO Jacket No. 560-102  
Print Order 61540  
Rise Business Services, LLC  
Job=AZ15 5/1/2019



Box Number= AZ15013



Claim Begin-End: AMC440214-AMC440222

5 Miscellaneous



AZ15013-6

AMC440098-AMC440515

November 10, 2016

John Steen  
PO Box 1507  
Congress, AZ 85332

Bureau of Land Management  
Arizona Office  
One N. Central Ave  
Box 55  
Phoenix, AZ 85004

To Whom It May Concern:

Please find enclosed a check in the amount of \$1,908.00 for the filing of nine (9) location notices for lode mining claims in Yavapai County.

The fee breakdown is as follows:

- \$20 Processing Fee (filing fee)
- \$37 Location Fee
- \$155 Maintenance Fee

Total due per claim \$212

Please send stamped copies to:

John Steen  
PO Box 1507  
Congress, AZ 85332

If you have any questions, please call me at 623-680-7447.

Thank you

John Steen

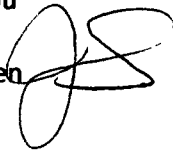

RECEIVED  
BLM AZ STATE OFFICE  
2016 NOV 15 P 1:48  
PHOENIX, ARIZONA

ANCI 0214



**NOTICE!!**

**These documents have been scanned!**

**Do not place un-scanned documents beneath this notice!**

**Do not remove this notice from this file!**

GPO Jacket No. 560-102  
Print Order 61540  
Rise Business Services, LLC  
Job=AZ15 5/1/2019



Box Number= AZ15013



Claim Begin-End: AMC440214-AMC440222

6 Location Notices-Amendments and Supporting Documents



AZ15013-6 AMC440098-AMC440515



# MINING CLAIM STATUS REPORT

Data Entered: 22 Nov 16

MTP Checked By: [Signature]

GEO Checked By: [Signature]

LEAD SERIAL NUMBER: AMC 440214 thru AMC 440222

**NUMBER OF CLAIMS & TYPE:**

9 LODE  
\_\_\_\_ PLACER  
\_\_\_\_ ASSOCIATION PLACER  
\_\_\_\_ MILL SITE  
\_\_\_\_ TUNNEL SITE

**CHARGES:**

Location Fee @ \$37 = \$ 333.00  
Processing Fee @ \$20 = \$ 180.00  
Maintenance Fee @ \$155 = \$ 1395.00  
Add'l Maint Fee for Assoc Placer = \$ \_\_\_\_\_  
**SUBTOTAL** \$ 1908.00  
Other Fees \$ \_\_\_\_\_  
Other Fees \$ \_\_\_\_\_  
**TOTAL** \$ 1908.00

TOTAL ACREAGE: \_\_\_\_\_ Per Claim  
(Placer Only)

NUMBER OF LOCATORS: 1

DOCUMENTS RECEIVED VIA: Over-the-Counter [ ] Mail  **TIMELY FILED:** Yes  No [ ]

LEGAL DESCRIPTION: T 13N R 10W SEC 3,4,9  
T \_\_\_\_\_ R \_\_\_\_\_ SEC \_\_\_\_\_  
T \_\_\_\_\_ R \_\_\_\_\_ SEC \_\_\_\_\_  
T \_\_\_\_\_ R \_\_\_\_\_ SEC \_\_\_\_\_  
T \_\_\_\_\_ R \_\_\_\_\_ SEC \_\_\_\_\_

BLM [ ] FOREST SERVICE [ ] \_\_\_\_\_ SUBJ TO PL 359: Yes [ ] No [ ]  
WILDERNESS AREA [ ] \_\_\_\_\_

SPLIT ESTATE: N/A [ ] SX [ ] PX [ ] OTHER [ ] \_\_\_\_\_  
SRHA [ ] Was proper Notice filed if located on SHRA Land? Yes [ ] No [ ]

RECONVEYED MINERALS ON BLM LAND REQUIRE OPENING ORDER FROM 1944 TO 1993:  
Open to Entry On \_\_\_\_\_ N/A [ ]

COMMENTS/STATUS: VOID [ ] PARTIALLY VOID [ ] PVT MINERALS [ ] WITHDRAWN LANDS [ ]  
OTHER [ ] \_\_\_\_\_

AMC 440214 - FILED w/ COUNTY PRIOR TO BEING LOCATED ON THE GROUND.

[ ] Claimant acknowledges that portions of the following claim(s) site(s) may be void or voidable.

Printed Name of Claimant \_\_\_\_\_ Signature of Claimant \_\_\_\_\_

\*\*\*\*\*FINAL ADJUDICATION\*\*\*\*\*

DATE 7/27/2017 INITIALS [Signature]

AMC 440214



PLEASE SEND TO

JOHN STEEN  
P.O. Box 1507  
CONGRESS, AZ 85332

LOCATION NOTICE FOR LODE MINING CLAIM

Amendment BLM Serial # \_\_\_\_\_

NOTICE IS HEREBY GIVEN that the SANDWICH #1  
\_\_\_\_\_ lode mining claim has been located  
by DWL PROPERTIES INC, whose current mailing  
address is 1209 E. COUNTY RD. 16E.  
LOVELAND, CO. 80537

RECEIVED  
BLM AZ DISTRICT OFFICE  
2016 NOV 15 P 1:50  
PHOENIX, ARIZONA  
BLM  
Date  
Stamp

The general course of this claim is EASTERLY TO WESTERLY and it is situated in YAVAPAI  
County, Arizona. This claim is 1500 feet in length and 600 feet in width.

20 Total Claim Acreage. This claim runs from the location monument on which this location notice  
is posted on the centerline of the claim approximately 750 feet in a WEST direction to the WEST  
end line and 1500 feet in a EAST direction to the EAST end line. This claim is marked by six  
monuments, one at each corner and one at the center of each end line of the claim.

The location monument on which this notice is posted is situated within Section 4, Township 13  
N, Range 10 W, Gila Salt River Base and Meridian, Arizona and this claim encompasses portions  
of the following quarter section(s), section(s), Township(s) and Range(s) SE 1/4 of the SE 1/4 of  
SEC. 4 EXTENDING INTO SW 1/4 of SW 1/4 of sec. 3. T. 13N. R. 10W  
Gila Salt River Base and Meridian, Arizona.

AMC140214

The locality of this claim with reference to some natural object or permanent monument and additional information  
(if any) concerning its locality are as follows: SURVAY MARKER (ALEA 3484) 55.7 DEGRESS  
4.132 FT. TO LOCATION MONUMENT, SANDWICH #1

\_\_\_\_\_ The above information is shown on the attached map.

DATED AND POSTED on the ground this 3 day of NOV., 2016.

LOCATOR(s)  AGENT  
Print Name(s) JOHN STEEN  
Signature(s) John Steen

**MINING CLAIM MAP**

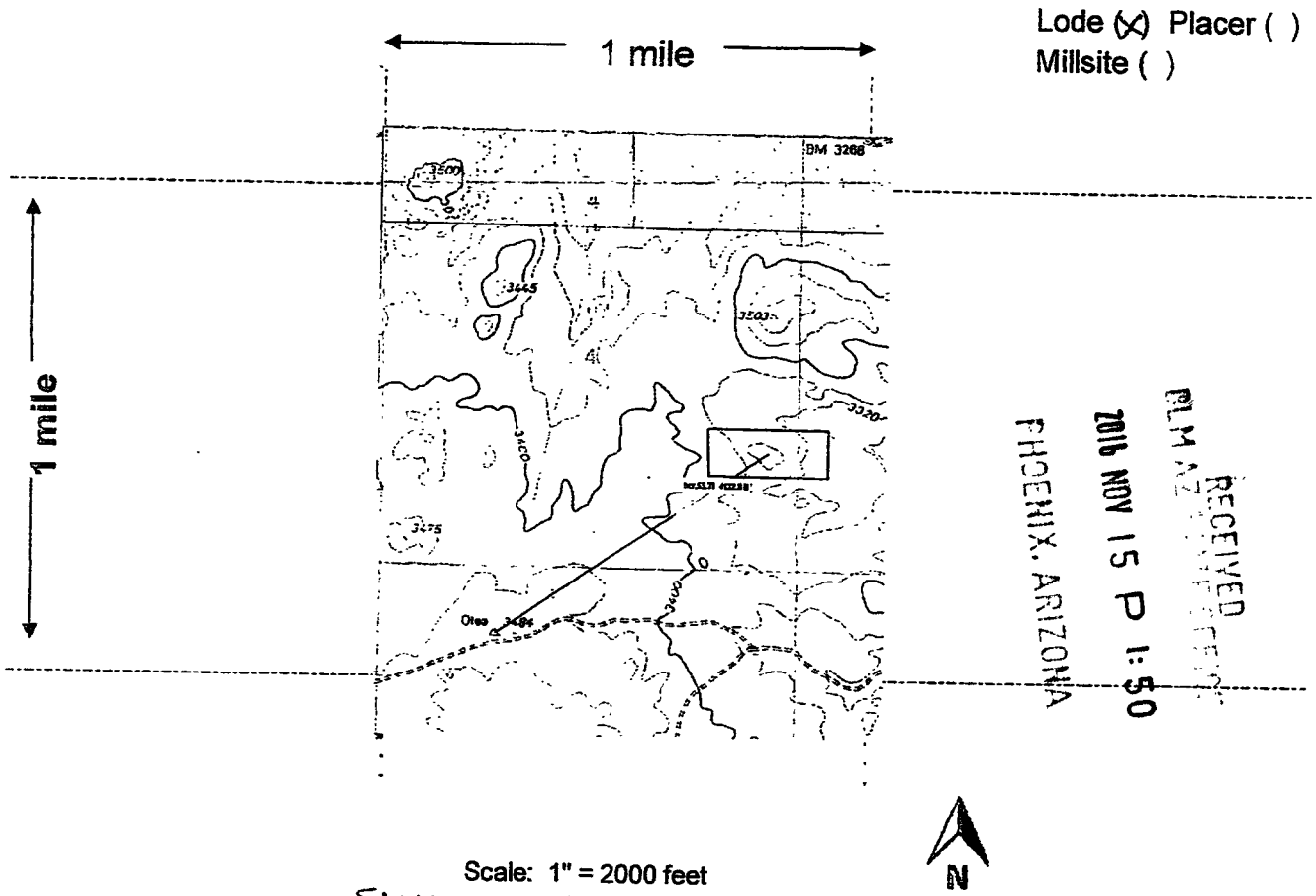

Scale: 1" = 2000 feet

1. The above map depicts the SANDWICH #1 mining claim, which is located in Section (s) 4, Township 13 N, Range 10 W, Gila and Salt River Base and Meridian, YAVAPAI County, Arizona. Total claim acreage is 20
2. The type of corner and location monuments used are as follows: 2X2 WOOD, REA TOPS, SCRIBED METAL TAGS DESCRIBING COR. & LOC. MON. IN BOTTLE.
3. The bearings and distances in degrees and feet between claim corners and to a public land survey monument are as depicted on the map.
4. If the claim is a placer or millsite claim with exterior limits conforming to legal subdivisions of the public survey, provide a legal description of the claim SURVAY MARKER (OLEA 3484) 55.7 DEGREE 132 FT TO LOC. MON. SE 1/4 OF SE 1/4 OF SEC 4 EXTENDING INTO SW 1/4 OF SW 1/4 OF SEC-3

Form MCF100a  
Revised July 2014

This form is available from the Arizona Geology Survey and may be reproduced.

ANC1140214



PLEASE SEND TO

JOHN STEEN  
PO BOX 1507  
CONGRESS, AZ  
85332



LOCATION NOTICE FOR LODE MINING CLAIM

Amendment BLM Serial # \_\_\_\_\_

NOTICE IS HEREBY GIVEN that the SANDWICH #2  
\_\_\_\_\_ lode mining claim has been located  
by DWL PROPERTIES, INC. whose current mailing  
address is 1209 E. COUNTY RD. 16E  
LOVELAND CO. 80537

RECEIVED  
BLM ARIZONA OFFICE  
2016 NOV 15 P 1:50  
PHOENIX, ARIZONA  
BLM  
Date  
Stamp

The general course of this claim is EAST+WEST and it is situated in YAVAPAI  
County, Arizona. This claim is 1500 feet in length and 600 feet in width.

20 Total Claim Acreage. This claim runs from the location monument on which this location notice  
is posted on the centerline of the claim approximately 10 feet in a E. direction to the E.  
end line and 1500 feet in a W. direction to the W. end line. This claim is marked by six  
monuments, one at each corner and one at the center of each end line of the claim.

The location monument on which this notice is posted is situated within Section 4, Township 13  
N, Range 10 W, Gila Salt River Base and Meridian, Arizona and this claim encompasses portions  
of the following quarter section(s), section(s), Township(s) and Range(s) SE 1/4 OF THE SE 1/4 OF SEC.  
4 T.13N. R.10W.

Gila Salt River Base and Meridian, Arizona.

The locality of this claim with reference to some natural object or permanent monument and additional information  
(if any) concerning its locality are as follows: SURVAY MARKER (OLEA 3484) 64.41 DEGRESS,  
3,845.5 FT. TO EAST END CENTER + 10 FT WEST TO LOC. MON.

SANDWICH #2 The above information is shown on the attached map.

DATED AND POSTED on the ground this 10 day of OCT., 2016.

LOCATOR(s)  AGENT

Print Name(s) JOHN STEEN

Signature(s) John Steen

ANCI 110215

**MINING CLAIM MAP**

Lode (X) Placer ( )  
Millsite ( )

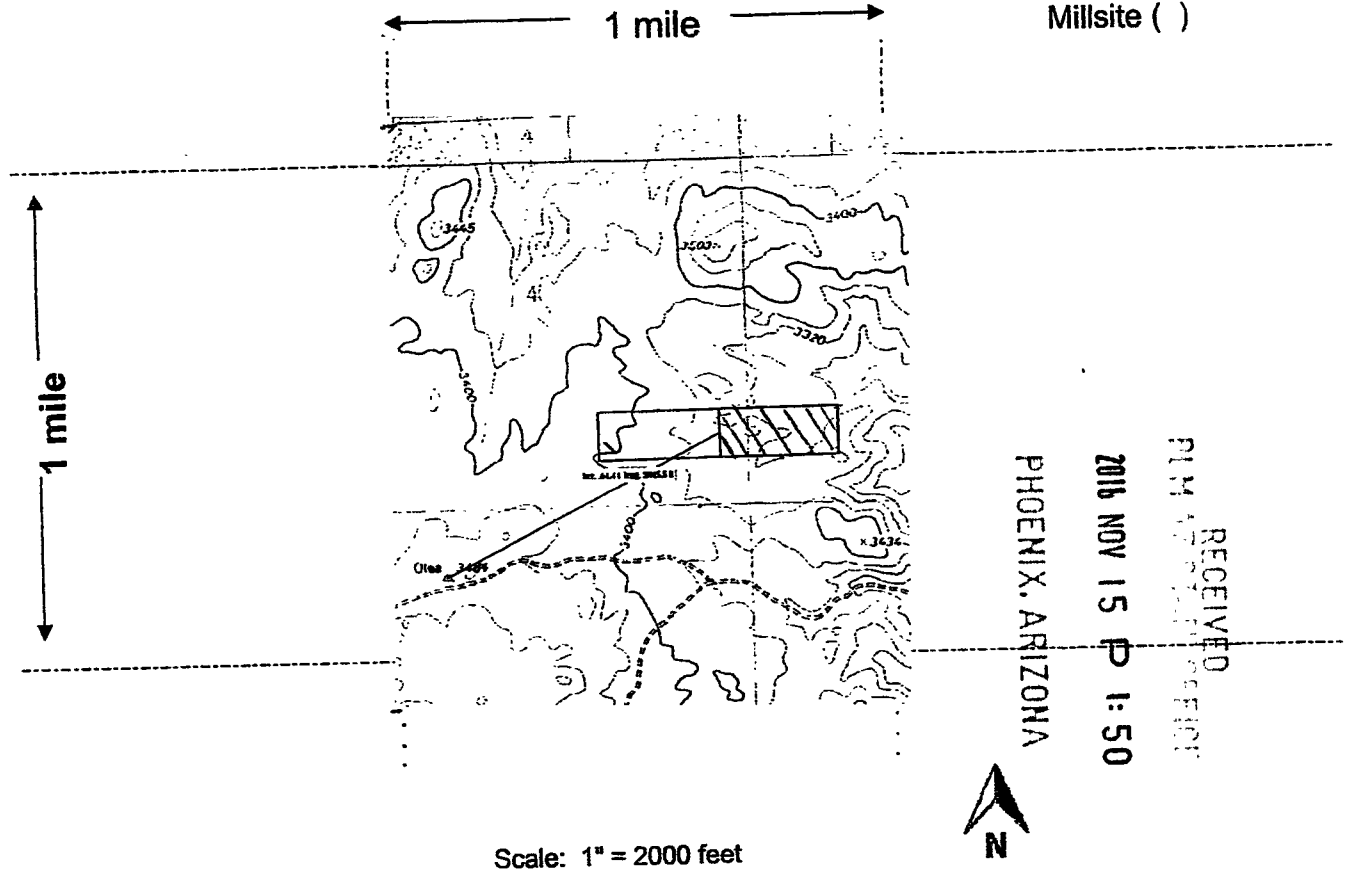

Scale: 1" = 2000 feet

- The above map depicts the SANDWICH #2 mining claim, which is located in Section (s) 4, Township 13 N., Range 10 W., Gila and Salt River Base and Meridian, YAVAPAI County, Arizona. Total claim acreage is 20
- The type of corner and location monuments used are as follows: 2x2 WOOD, RED TOP, POSTS SCRIBED METAL TAGS, DISCRIBING COR. LOC. MON. IN BOTTLE
- The bearings and distances in degrees and feet between claim corners and to a public land survey monument are as depicted on the map.
- If the claim is a placer or millsite claim with exterior limits conforming to legal subdivisions of the public survey, provide a legal description of the claim SURVAY MARKER (OLEA 3484) 64.41 DEGRESS. 3,845.5 FT. TO E. END. CENTER. 10 FT. W. TO LOC. MON. SANDWICH #2

Form MCF100a  
Revised July 2014

This form is available from the Arizona Geology Survey and may be reproduced.



PLEASE SEND TO:

JOHN STEEN  
P.O. Box 1507  
CONGRESS, AZ 85332

LOCATION NOTICE FOR LODE MINING CLAIM

Amendment BLM Serial # \_\_\_\_\_

NOTICE IS HEREBY GIVEN that the SANDWICH #3  
\_\_\_\_\_ lode mining claim has been located  
by D.W.L. PROPERTIES, INC. whose current mailing  
address is 1209 E. COUNTY RD. 16 E.  
LOVELAND, CO. 80537

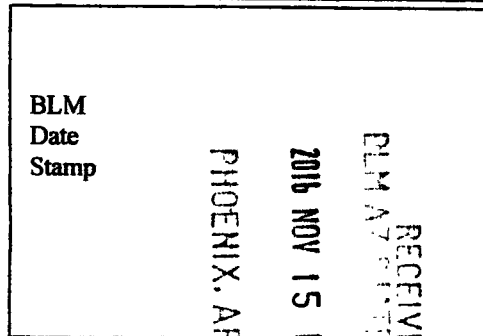

The general course of this claim is EAST + WEST and it is situated in YAVAPAI  
County, Arizona. This claim is 1500 feet in length and 600 feet in width.

\_\_\_\_\_ Total Claim Acreage. This claim runs from the location monument on which this location notice  
is posted on the centerline of the claim approximately 10 feet in a W. direction to the W.  
end line and 1500 feet in a E. direction to the E. end line. This claim is marked by six  
monuments, one at each corner and one at the center of each end line of the claim.

The location monument on which this notice is posted is situated within Section 4, Township 13  
N., Range 10 W., Gila Salt River Base and Meridian, Arizona and this claim encompasses portions  
of the following quarter section(s), section(s), Township(s) and Range(s) SE 1/4 OF THE SE 1/4 OF SEC.  
4. EXTENDING INTO SW 1/4 OF THE SW 1/4 OF SEC. 3 T. 13N. R. 10W.

Gila Salt River Base and Meridian, Arizona.

The locality of this claim with reference to some natural object or permanent monument and additional information  
(if any) concerning its locality are as follows: SURVAY MARKER (DLEA 3484) 64.41 DEGREE,  
3,845.5 FT. WEST END CENTER 710 FT. EAST TO LOC. MON.

SANDWICH #3 The above information is shown on the attached map.

DATED AND POSTED on the ground this 10 day of DEC., 2016.

LOCATOR(s)  AGENT

Print Name(s) JOHN STEEN

Signature(s) John Steen

AR110410216

**MINING CLAIM MAP**

Lode (X) Placer ( )  
Millsite ( )

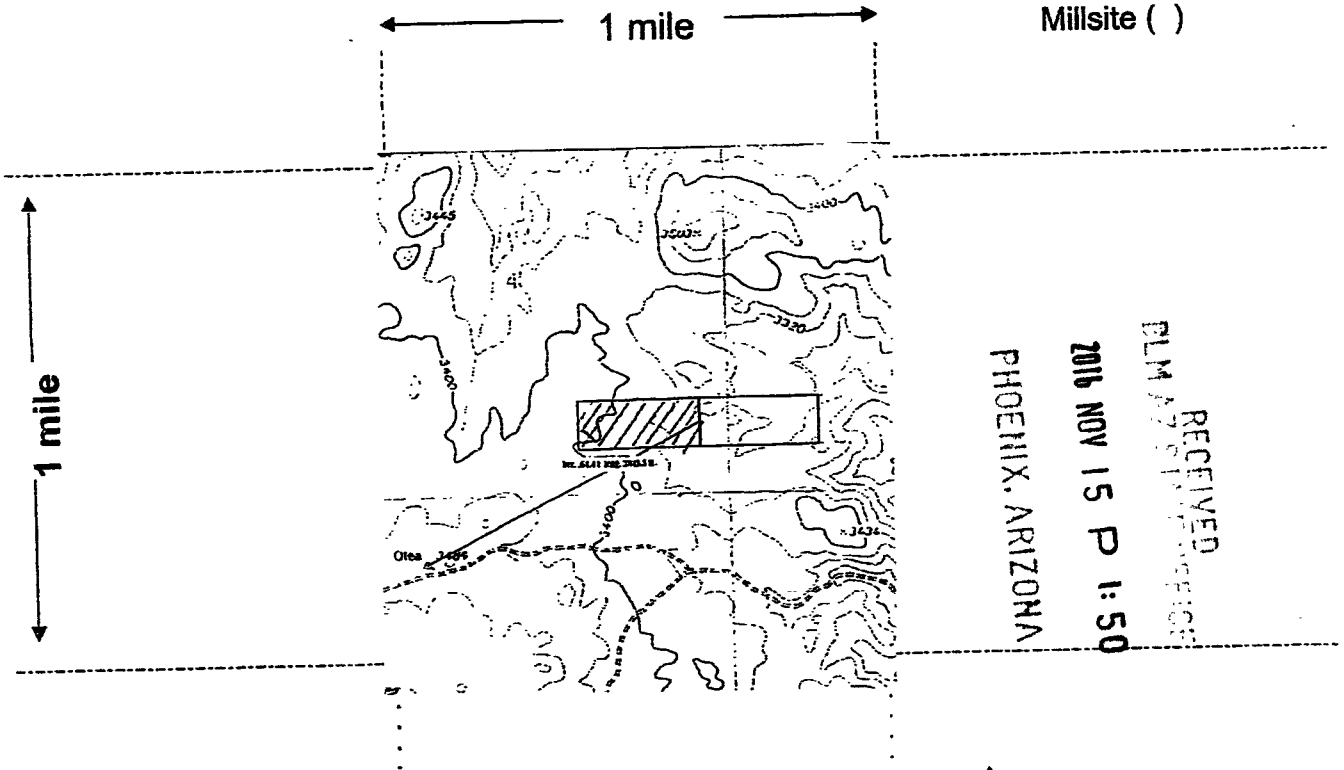

Scale: 1" = 2000 feet



1. The above map depicts the SANDWICH # 3 mining claim, which is located in Section (s) 4, Township 13 N., Range 10 W., Gila and Salt River Base and Meridian, YAVAPAI County, Arizona. Total claim acreage is 20

2. The type of corner and location monuments used are as follows: 2x2 WOOD, RED TOP  
SCRIBE METAL TAGS, DISCRIBING. COR + LOC. MON. IN BOTTLE

3. The bearings and distances in degrees and feet between claim corners and to a public land survey monument are as depicted on the map.

4. If the claim is a placer or millsite claim with exterior limits conforming to legal subdivisions of the public survey, provide a legal description of the claim SURVAY MARKER (OLEA 3484) 64.41 DEGRESS.  
38 45.5 FT. TOW. END CENTER + 10 FT. F. TO LOC. MON. SANDWICH # 3

Form MCF100a  
Revised July 2014

This form is available from the Arizona Geology Survey and may be reproduced.

ANC 11/10/216

PLEASE SEND TO:-

JOHN STEEN  
P.O. Box 1507  
CONGRESS, AZ 85332



LOCATION NOTICE FOR LODE MINING CLAIM

Amendment BLM Serial # \_\_\_\_\_

NOTICE IS HEREBY GIVEN that the SUNCLOUD#1

\_\_\_\_\_ lode mining claim has been located

by DWL PROPERTIES, INC whose current mailing

address is 1209 E. COUNTY RD 16E

LOVELAND, CO. 80537

RECEIVED  
BLM AZ DIST OFFICE  
2016 NOV 15 P 1:49  
PHOENIX, ARIZONA

The general course of this claim is NORTH TO SOUTH and it is situated in YAVAPAI

County, Arizona. This claim is 1500 feet in length and 600 feet in width.

20 Total Claim Acreage. This claim runs from the location monument on which this location notice

is posted on the centerline of the claim approximately 10 feet in a NORTH direction to the NORTH

end line and 1500 feet in a SOUTH direction to the SOUTH end line. This claim is marked by six

monuments, one at each corner and one at the center of each end line of the claim.

The location monument on which this notice is posted is situated within Section 9, Township 13

N, Range 10 W, Gila Salt River Base and Meridian, Arizona and this claim encompasses portions

of the following quarter section(s), section(s), Township(s) and Range(s) NE QTR, SEC 9, TN 13N, R 10W, G4 SRM ARIZONA

Gila Salt River Base and Meridian, Arizona.

The locality of this claim with reference to some natural object or permanent monument and additional information

(if any) concerning its locality are as follows: FROM SURVEY MARKER (OLEA 3484) 1.258 FT. AT

122.4 DEGRESS TO SW. COR. SUNCLOUD#3 + 900 FT. EAST TO NORTH END CENTER

10 FT. SOUTH TO LOC. MON. SUNCLOUD#1 The above information is shown on the attached map.

DATED AND POSTED on the ground this 22 day of Sept., 2016.

LOCATOR(s)  AGENT

Print Name(s) JOHN STEEN

Signature(s) John Steen

11010217



**MINING CLAIM MAP**

Lode (X) Placer ( )  
Millsite ( )

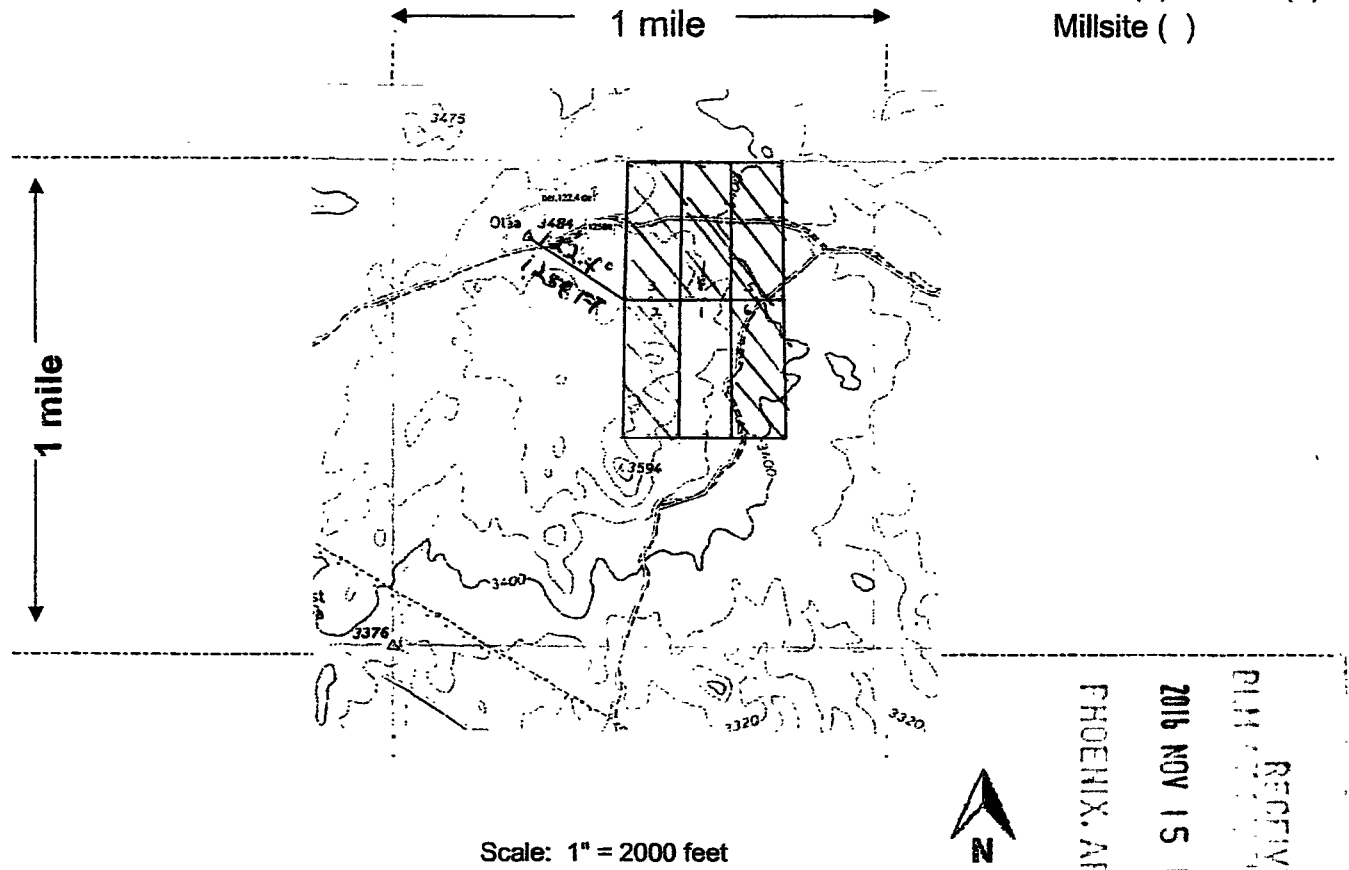

Scale: 1" = 2000 feet

1. The above map depicts the SUNCLOUD # 1 mining claim, which is located in Section (s) 9, Township 13 N, Range 10 W, Gila and Salt River Base and Meridian, YAVAPAI County, Arizona. Total claim acreage is 20

2. The type of corner and location monuments used are as follows: 2x2 WOOD POSTS, 4 FT ABOVE GROUND, METAL TAGS MARKING CORNERS, BOTTLES WITH LOCATION NOTICES

3. The bearings and distances in degrees and feet between claim corners and to a public land survey monument are as depicted on the map.

4. If the claim is a placer or millsite claim with exterior limits conforming to legal subdivisions of the public survey, provide a legal description of the claim FROM SURVEY MARKER (OLEA 3484) 1258 FT. AT 122° DEGREE TO SW COR. SUNCLOUD # 3 AND 900 FT. TO NORTH END CENTER, AND 10 FT SOUTH TO LOC. MON. SUNCLOUD # 1

RECEIVED  
 PHOENIX, ARIZONA  
 2016 NOV 15 PM 4:19

A110440217

Form MCF100a  
Revised July 2014

PLEASE SEND TO:

JOHN STEEN  
P.O. BOX 1507  
CONGRESS, AZ  
85332



LOCATION NOTICE FOR LODE MINING CLAIM

Amendment BLM Serial # \_\_\_\_\_

NOTICE IS HEREBY GIVEN that the SUNCLOWD#2  
\_\_\_\_\_ lode mining claim has been located

by DWL PROPERTIES, INC whose current mailing  
address is 1209 E. COUNTY RD 16E  
LOVELAND, CO. 80537

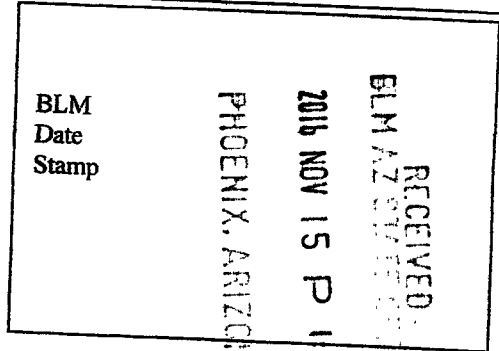

The general course of this claim is NORTH TO SOUTH and it is situated in YAVAPAI  
County, Arizona. This claim is 1500 feet in length and 600 feet in width.

20 Total Claim Acreage. This claim runs from the location monument on which this location notice  
is posted on the centerline of the claim approximately 10 feet in a NORTH direction to the NORTH  
end line and 1500 feet in a SOUTH direction to the SOUTH end line. This claim is marked by six  
monuments, one at each corner and one at the center of each end line of the claim.

The location monument on which this notice is posted is situated within Section 9, Township 13  
N, Range 10 W, Gila Salt River Base and Meridian, Arizona and this claim encompasses portions  
of the following quarter section(s), section(s), Township(s) and Range(s) \_\_\_\_\_

NE QTR, SEC 9, TN 13N, R 10W, G4 SRM ARIZONA  
Gila Salt River Base and Meridian, Arizona.

The locality of this claim with reference to some natural object or permanent monument and additional information  
(if any) concerning its locality are as follows: FROM SURVAY MARKER (OLEA 3484) 125 FT AT 1224'  
DEGRESS TO SW. COR. SUNCLOWD#3 AND 300 FT. TO SOUTH END CENTER, 110 FT. SOUTH  
TO LOC. MON. SUNCLOWD#2

The above information is shown on the attached map.  
DATED AND POSTED on the ground this 22 day of SEPT., 2016.

LOCATOR(s)  AGENT

Print Name(s) JOHN STEEN

Signature(s) [Handwritten Signature]

AH C 4 4 0 2 1 8

# MINING CLAIM MAP

Lode (X) Placer ( )  
Millsite ( )

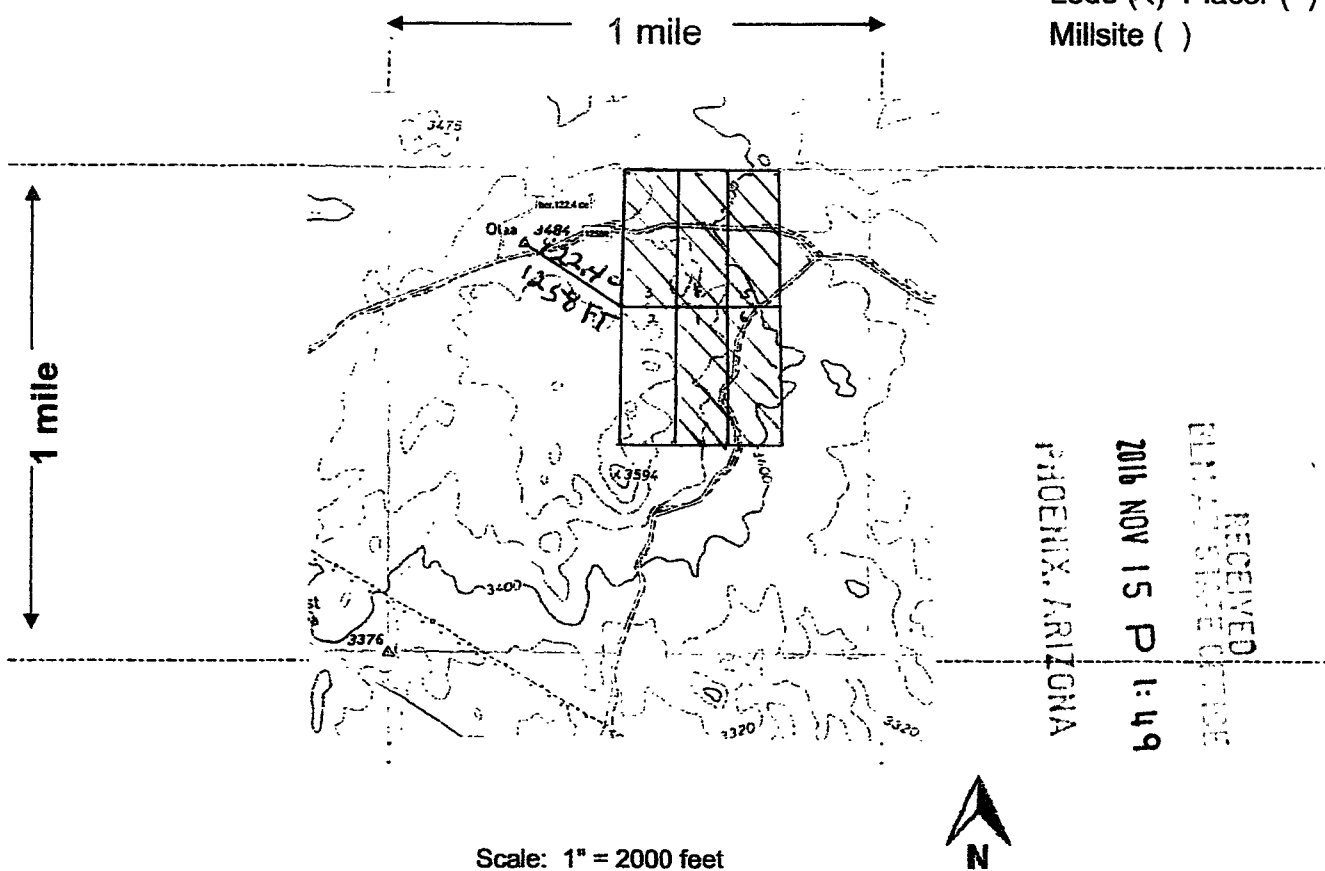

RECEIVED  
 EL PASO STATE OFFICE  
 2016 NOV 15 P 1:49  
 PHOENIX, ARIZONA

Scale: 1" = 2000 feet



- The above map depicts the SUNCLOUD #2 mining claim, which is located in Section (s) 4, Township 13 N, Range 10 W, Gila and Salt River Base and Meridian, YAVAPAI County, Arizona. Total claim acreage is 20
- The type of corner and location monuments used are as follows: 2x2 WOOD POSTS, 4 FT ABOVE GROUND, METAL TAGS MARKING CORNERS, BOTTLES WITH LOCATION NOTICES
- The bearings and distances in degrees and feet between claim corners and to a public land survey monument are as depicted on the map.
- If the claim is a placer or millsite claim with exterior limits conforming to legal subdivisions of the public survey, provide a legal description of the claim FROM SURVAY MARKER (OLEA 3484) 1258 FT. AT 122 1/2 DEGREES TO SW COR. SUNCLOUD #3 AND 300 FT. EAST TO SOUTH END CENTER, AND 10 FT. SOUTH TO LOC. MON SUNCLOUD #2

Form MCF100a  
Revised July 2014

AH0440218



PLEASE SEND TO  
JOHN STEEN  
P.O. BOX 1507  
CONGRESS, AZ 85332

LOCATION NOTICE FOR LODE MINING CLAIM

Amendment BLM Serial # \_\_\_\_\_

NOTICE IS HEREBY GIVEN that the SUNCLOUD #3  
\_\_\_\_\_ lode mining claim has been located

by DWL PROPERTIES, INC whose current mailing  
address is 1209 E. COUNTY RD 16E  
LOVELAND, CO. 80537

RECEIVED  
BLM AZ DISTRICT OFFICE  
2016 NOV 15 P 1:10  
PHOENIX, ARIZONA

The general course of this claim is NORTH TO SOUTH and it is situated in YAVAPAI  
County, Arizona. This claim is 1500 feet in length and 600 feet in width.

20 Total Claim Acreage. This claim runs from the location monument on which this location notice  
is posted on the centerline of the claim approximately 10 feet in a SOUTH direction to the SOUTH  
end line and 1500 feet in a NORTH direction to the NORTH end line. This claim is marked by six  
monuments, one at each corner and one at the center of each end line of the claim.

The location monument on which this notice is posted is situated within Section 9, Township 13  
N, Range 10 W, Gila Salt River Base and Meridian, Arizona and this claim encompasses portions  
of the following quarter section(s), section(s), Township(s) and Range(s) \_\_\_\_\_

NE QTR, SEC 9, TN 13N, R 10W, G4 SRM ARIZONA  
Gila Salt River Base and Meridian, Arizona.

The locality of this claim with reference to some natural object or permanent monument and additional information  
(if any) concerning its locality are as follows: SURVAY MARKER (OLEA 3484) 1.250 FT. AT 122.5 FT  
DEGRESS TO S.W. COR. SUNCLOUD #3 4300 FT E. TO S. END CENTER 410 FT. N. TO LOC.  
MON. SUNCLOUD #3

The above information is shown on the attached map.  
DATED AND POSTED on the ground this 22 day of SEPT., 2016.

LOCATOR(s)  AGENT

Print Name(s) JOHN STEEN

Signature(s) [Handwritten Signature]

AH C 14 0 2 1 9

**MINING CLAIM MAP**

Lode (X) Placer ( )  
Millsite ( )

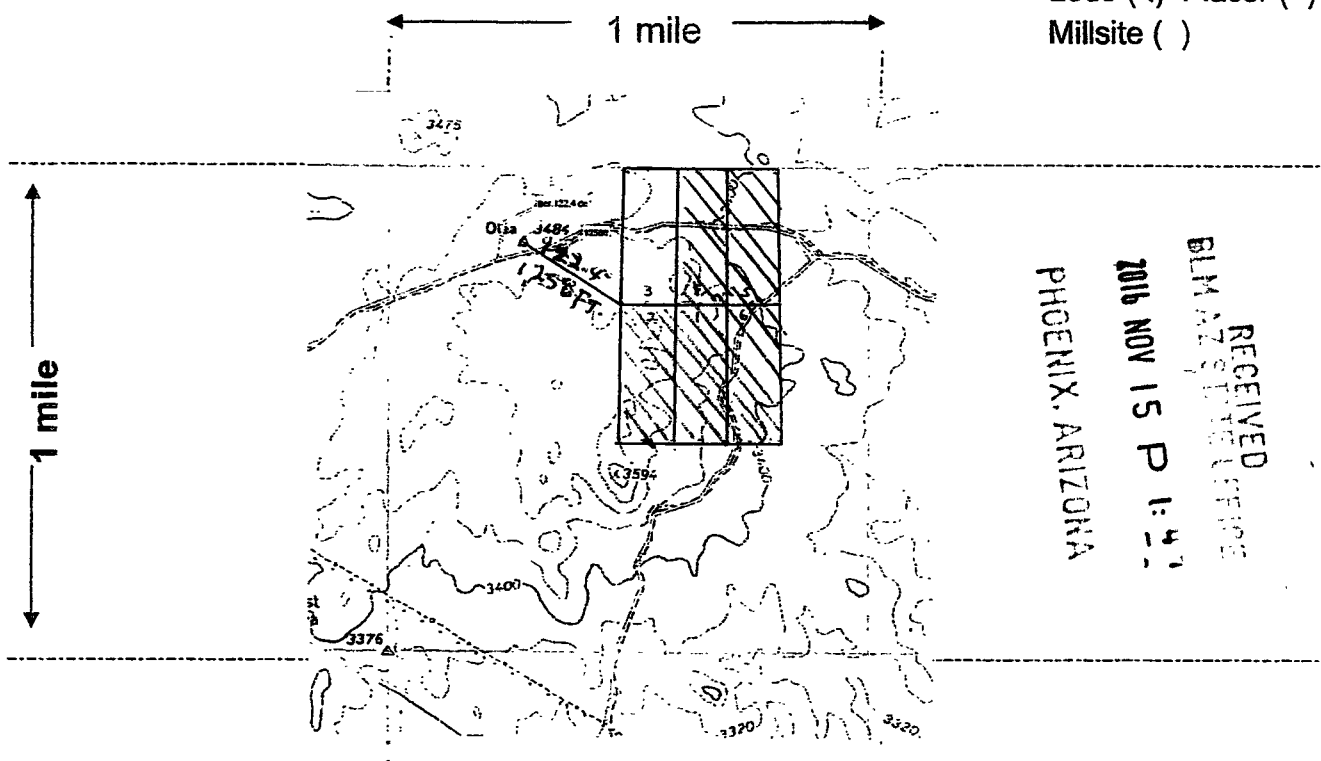

Scale: 1" = 2000 feet



1. The above map depicts the SUNCLOUD #3 mining claim, which is located in Section (s) 9, Township 13 N, Range 10 W, Gila and Salt River Base and Meridian, YAVAPAI County, Arizona. Total claim acreage is 20
2. The type of corner and location monuments used are as follows: 2x2 WOOD POSTS, 4 FT ABOVE GROUND, METAL TAGS MARKING CORNERS, BOTTLES WITH LOCATION NOTICES
3. The bearings and distances in degrees and feet between claim corners and to a public land survey monument are as depicted on the map.
4. If the claim is a placer or millsite claim with exterior limits conforming to legal subdivisions of the public survey, provide a legal description of the claim FROM SURVEY MARKER (OLEA 3484) 1258 FT. AT 124 DEGREES TO SW COR. SUNCLOUD #3 AND 300 FT EAST TO SOUTH END CENTER, AND 10 NORTH TO LOC. MON. SUNCLOUD #3

Form MCF100a  
Revised July 2014

AH1440219





PLEASE SEND TO  
JOHN STEEN  
P.O. Box 1507  
CONGRESS, AZ 85332

LOCATION NOTICE FOR LODE MINING CLAIM

Amendment BLM Serial # \_\_\_\_\_

NOTICE IS HEREBY GIVEN that the SUNCLOUD #4  
\_\_\_\_\_ lode mining claim has been located

by DWL PROPERTIES, INC whose current mailing  
address is 1209 E. COUNTY RD 16E  
LOVELAND, CO. 80537

RECEIVED  
BLM DISTRICT OFFICE  
PHOENIX, ARIZONA  
28 NOV 15 P 1:47  
BLM  
Date  
Stamp

The general course of this claim is NORTH TO SOUTH and it is situated in YAVAPAI  
County, Arizona. This claim is 1500 feet in length and 1000 feet in width.

20 Total Claim Acreage. This claim runs from the location monument on which this location notice  
is posted on the centerline of the claim approximately 10 feet in a S. direction to the SOUTH  
end line and 1500 feet in a NORTH direction to the NORTH end line. This claim is marked by six  
monuments, one at each corner and one at the center of each end line of the claim.

The location monument on which this notice is posted is situated within Section 9, Township 13  
N, Range 10 W, Gila Salt River Base and Meridian, Arizona and this claim encompasses portions  
of the following quarter section(s), section(s), Township(s) and Range(s) \_\_\_\_\_

NE QTR, SEC 9, TN 13N, R 10W, G4 SRM ARIZONA  
Gila Salt River Base and Meridian, Arizona.

The locality of this claim with reference to some natural object or permanent monument and additional information  
(if any) concerning its locality are as follows: SURVAY MARKER (GLEA 3484) 1,258 FT. AT 122.5°  
DEGRESS TO S.W. COR. SUNCLOUD #3 900 FT. TO SOUTH END CENTER, 9-10 FT. NORTH TO  
LOC. MON. SUNCLOUD #4

The above information is shown on the attached map.  
DATED AND POSTED on the ground this 22 day of SEPT., 2016.

LOCATOR(s)  AGENT

Print Name(s) JOHN STEEN

Signature(s) [Handwritten Signature]

AHCH440220

**MINING CLAIM MAP**

Lode (X) Placer ( )  
Millsite ( )

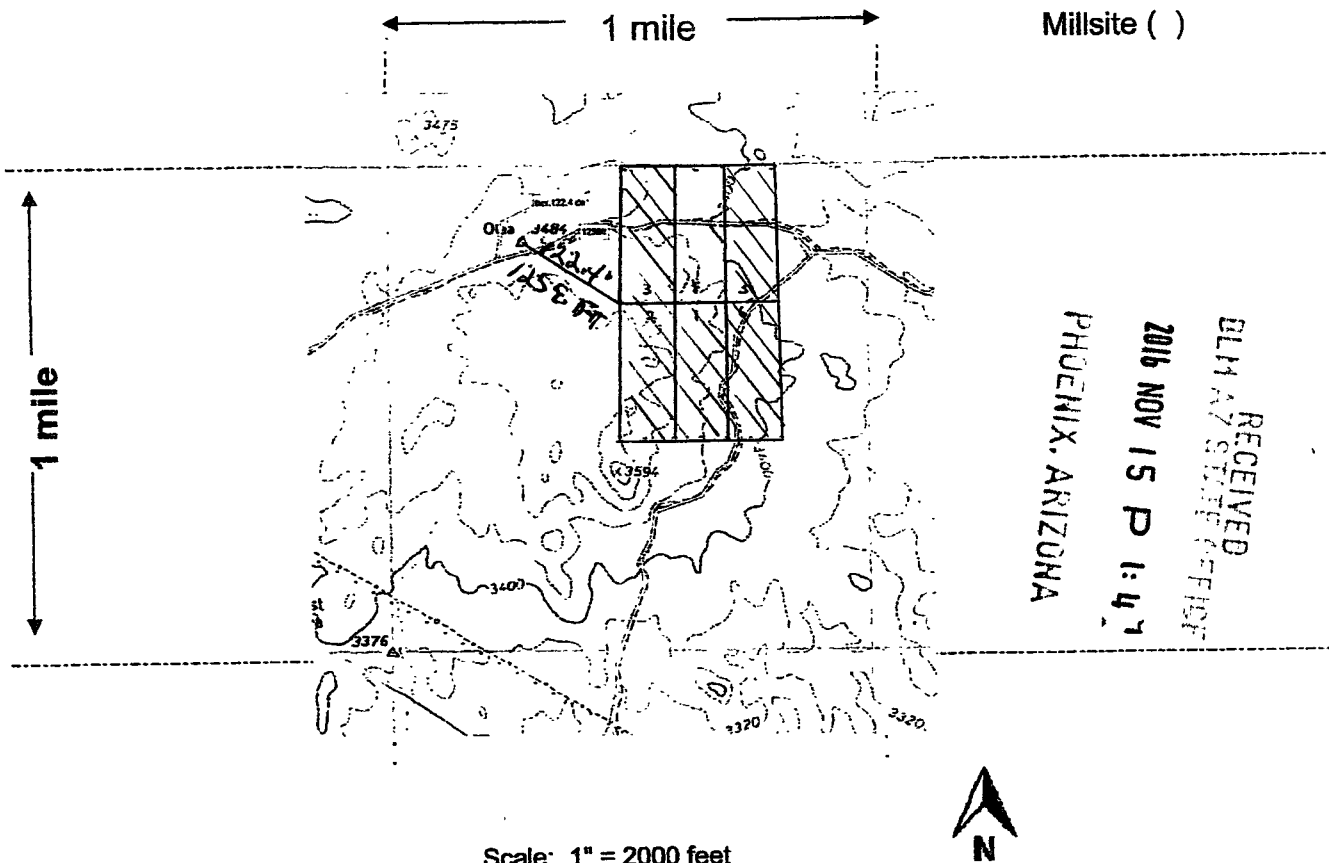

Scale: 1" = 2000 feet



1. The above map depicts the SUNCLOUD #4 mining claim, which is located in Section (s) 9, Township 13 N, Range 10 W, Gila and Salt River Base and Meridian, YAVAPAI County, Arizona. Total claim acreage is 20
2. The type of corner and location monuments used are as follows: 2x2 WOOD POSTS, 4 FT ABOVE GROUND, METAL TAGS MARKING CORNERS, BOTTLES WITH LOCATION NOTICES
3. The bearings and distances in degrees and feet between claim corners and to a public land survey monument are as depicted on the map.
4. If the claim is a placer or millsite claim with exterior limits conforming to legal subdivisions of the public survey, provide a legal description of the claim FROM SURVEY MARKER (OLEA3484) 1258 FT. AT 122 1/2 DEGREES TO SW COR. SUNCLOUD #3 AND 906 FT. TO SOUTH END CENTER, AND 10 FT. NORTH TO LOC. MON. SUNCLOUD #4

Form MCF100a  
Revised July 2014

AHC140220



PLEASE SEND TO

JOHN STEEN  
P.O. BOX 1507  
CONGRESS, AZ 85332

LOCATION NOTICE FOR LODE MINING CLAIM

Amendment BLM Serial # \_\_\_\_\_

NOTICE IS HEREBY GIVEN that the SUNCLOUD #5  
\_\_\_\_\_ lode mining claim has been located

by DWL PROPERTIES, INC whose current mailing  
address is 1209 E. COUNTY RD 16E  
LOVELAND, CO. 80537

RECEIVED  
BLM AZ STATE OFFICE  
2016 NOV 15 P 1:50  
PHOENIX, ARIZONA  
BLM  
Date  
Stamp

The general course of this claim is NORTH TO SOUTH and it is situated in YAVAPAI  
County, Arizona. This claim is 1500 feet in length and 600 feet in width.

20 Total Claim Acreage. This claim runs from the location monument on which this location notice  
is posted on the centerline of the claim approximately 10 feet in a S. direction to the S.  
end line and 1500 feet in a N. direction to the N. end line. This claim is marked by six  
monuments, one at each corner and one at the center of each end line of the claim.

The location monument on which this notice is posted is situated within Section 9, Township 13  
N, Range 10 W, Gila Salt River Base and Meridian, Arizona and this claim encompasses portions  
of the following quarter section(s), section(s), Township(s) and Range(s) \_\_\_\_\_

NE. QTR, SEC 9, TN 13N, R 10W, G4 SRM ARIZONA  
Gila Salt River Base and Meridian, Arizona.

The locality of this claim with reference to some natural object or permanent monument and additional information  
(if any) concerning its locality are as follows: SURVAY MARKER (DLEA 3484) 125 FT. AT  
122.4° DEGRESS. TO SW. COR. SUNCLOUD #3 + 1500' EAST TO S. END CENTER, AND  
10 FT. TO LOC. MON. SUNCLOUD #5 The above information is shown on the attached map.

DATED AND POSTED on the ground this 22 day of SEPT., 2016.

LOCATOR(s)  AGENT

Print Name(s) JOHN STEEN

Signature(s) [Handwritten Signature]

AHC440221

**MINING CLAIM MAP**

Lode (X) Placer ( )  
Millsite ( )

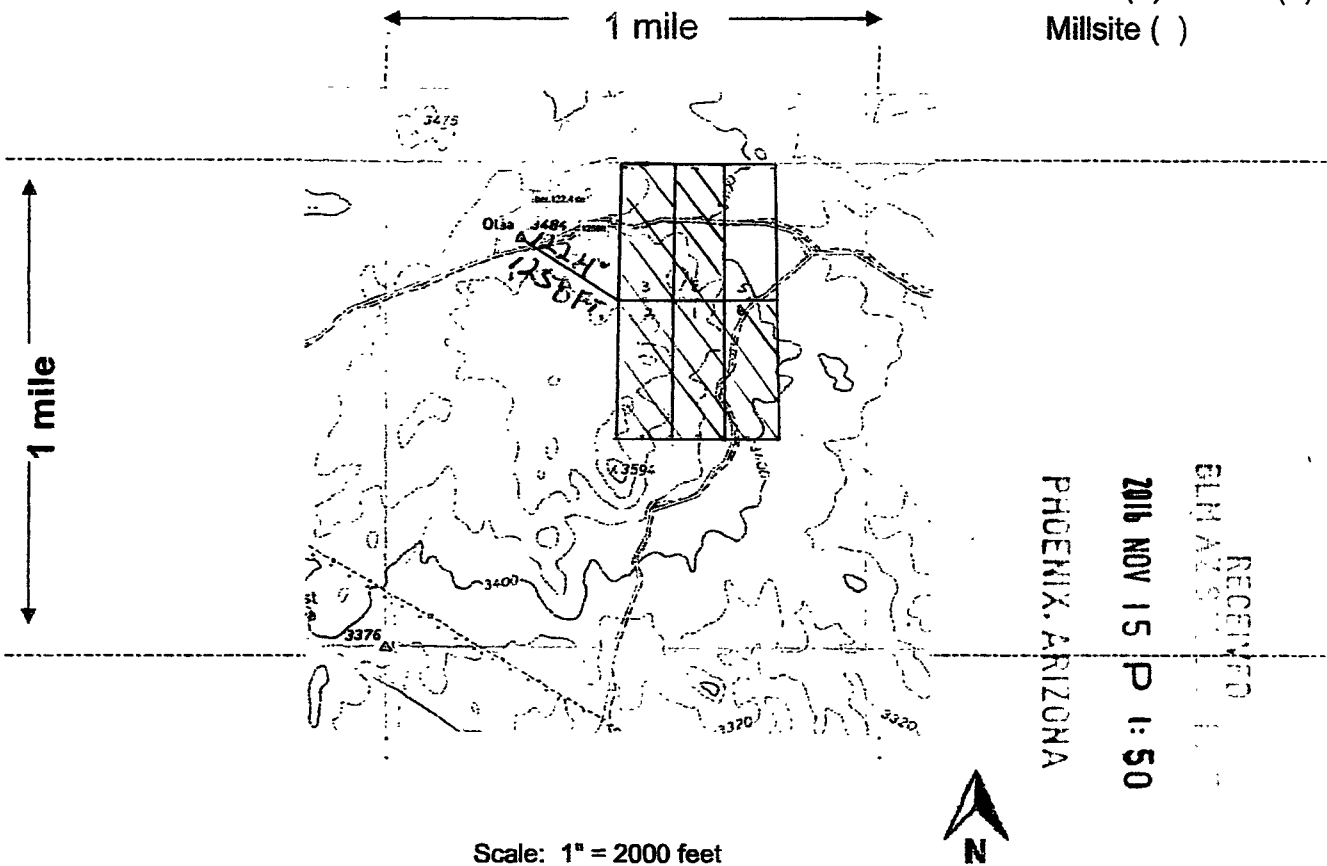

Scale: 1" = 2000 feet

1. The above map depicts the SUNCLOUD #5 mining claim, which is located in Section (s) 9, Township 13 N, Range 10 W, Gila and Salt River Base and Meridian, YAVAPAI County, Arizona. Total claim acreage is 20
2. The type of corner and location monuments used are as follows: 2x2 WOOD POSTS, 4 FT ABOVE GROUND, METAL TAGS MARKING CORNERS, BOTTLES WITH LOCATION NOTICES
3. The bearings and distances in degrees and feet between claim corners and to a public land survey monument are as depicted on the map.
4. If the claim is a placer or millsite claim with exterior limits conforming to legal subdivisions of the public survey, provide a legal description of the claim FROM SURVEY MARKER (OLEA3484) 1258 FT. AT 122 1/2 DEGREES TO SW COR. SUNCLOUD #3 AND 1500 EAST TO SOUTH END CENTER, AND 10 FT TO LOC. MON. SUNCLOUD #5

Form MCF100a  
Revised July 2014

AHCH440221



PLEASE SEND TO  
JOHN STEEN  
P.O. Box 1507  
CONGRESS, AZ 85332

LOCATION NOTICE FOR LODE MINING CLAIM

Amendment BLM Serial # \_\_\_\_\_

NOTICE IS HEREBY GIVEN that the SUNCLOUD#6  
\_\_\_\_\_ lode mining claim has been located

by DWL PROPERTIES, INC whose current mailing  
address is 1209 E. COUNTY RD 16E  
LOVELAND, CO. 80537

RECEIVED  
BLM AZ STATE OFFICE  
2016 NOV 15 P 1:50  
PHOENIX, ARIZONA  
BLM  
Date  
Stamp

The general course of this claim is NORTH TO SOUTH and it is situated in YAVAPAI  
County, Arizona. This claim is 1500 feet in length and 600 feet in width.

20 Total Claim Acreage. This claim runs from the location monument on which this location notice  
is posted on the centerline of the claim approximately 10 feet in a N. direction to the N.  
end line and 1500 feet in a S. direction to the S. end line. This claim is marked by six  
monuments, one at each corner and one at the center of each end line of the claim.

The location monument on which this notice is posted is situated within Section 9, Township 13  
N, Range 10 W, Gila Salt River Base and Meridian, Arizona and this claim encompasses portions  
of the following quarter section(s), section(s), Township(s) and Range(s) \_\_\_\_\_  
NE QTR, SEC 9, TN 13N, R 10W, G4 SRM ARIZONA  
Gila Salt River Base and Meridian, Arizona.

The locality of this claim with reference to some natural object or permanent monument and additional information  
(if any) concerning its locality are as follows: SURVAY MARKER (OLEA 3484) 125 FT. AT 122.4°  
DEGRESS TO SW COR. SUNCLOUD#3 + 1500 FT. TO END CENTER + 10 FT. SOUTH TO  
LOC. MON. SUNCLOUD#6

The above information is shown on the attached map.  
DATED AND POSTED on the ground this 22 day of SEPT., 2016.

LOCATOR(s)  AGENT  
Print Name(s) JOHN STEEN  
Signature(s) John Steen

AHC440222



**MINING CLAIM MAP**

Lode (X) Placer ( )  
Millsite ( )

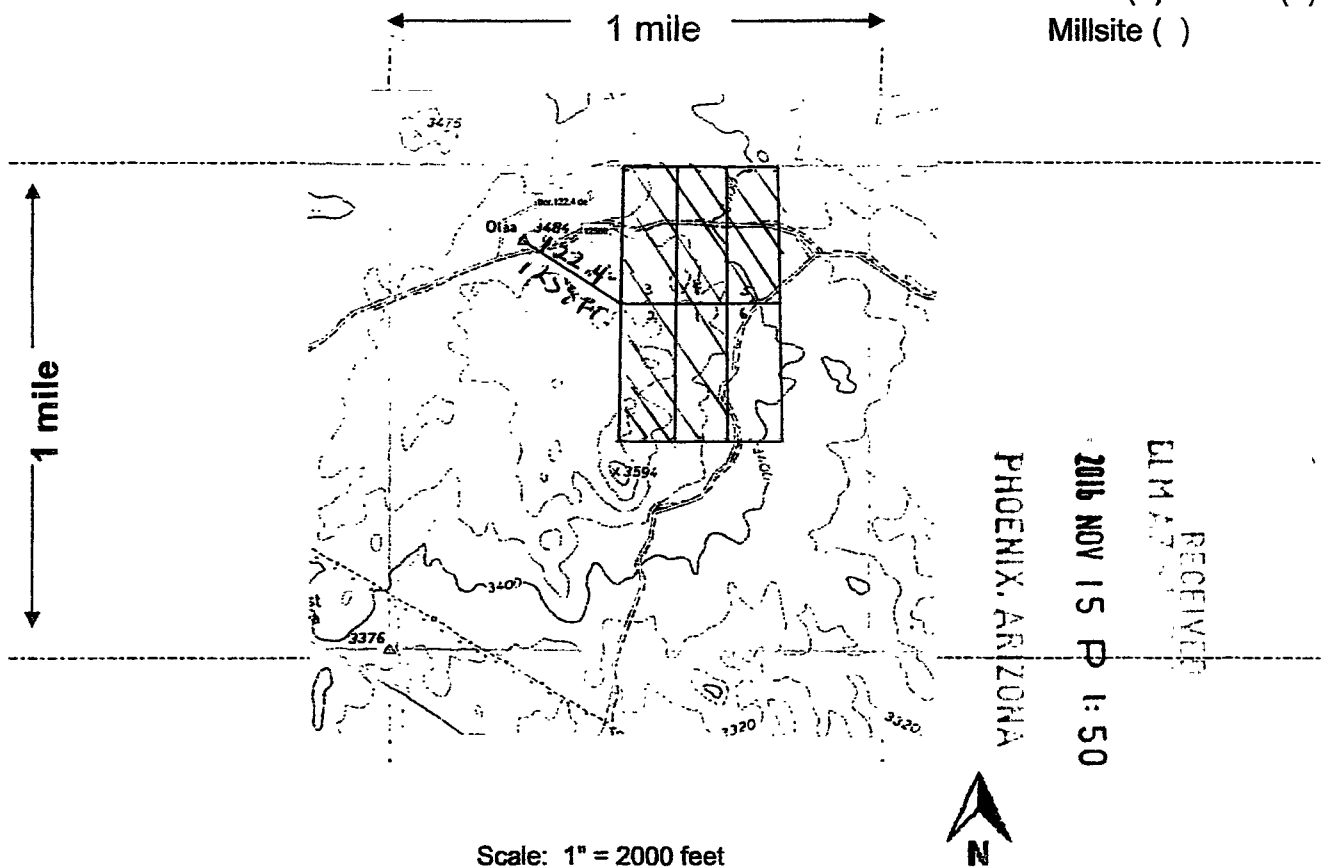

Scale: 1" = 2000 feet

1. The above map depicts the SUNCLOUD #6 mining claim, which is located in Section (s) 9, Township 13 N, Range 10 W, Gila and Salt River Base and Meridian, YAVAPAI County, Arizona. Total claim acreage is 20

2. The type of corner and location monuments used are as follows: 2x2 WOOD POSTS, 4 FT ABOVE GROUND, METAL TAGS MARKING CORNERS, BOTTLES WITH LOCATION NOTICES

3. The bearings and distances in degrees and feet between claim corners and to a public land survey monument are as depicted on the map.

4. If the claim is a placer or millsite claim with exterior limits conforming to legal subdivisions of the public survey, provide a legal description of the claim FROM SURVEY MARKER (OLEA3484) 1258 FT. AT 122 1/2 DEGREES TO SW COR. SUNCLOUD #3 AND 150 FT EAST TO END CENTER, AND 10 FT. SOUTH TO LOC. MON. SUNCLOUD #6

Form MCF100a  
Revised July 2014

Input Parameters for Geographic Report with Land

System Id = CR

Admin State = AZ

Geo State =

Casetype Begins With

Case Disp Txt = AUTHORIZED, CANCELLED, EXPIRED, PENDING, REJECTED, RELINQUISHED, WITHDRAWN

Mer Twp Rng =

Section =

Mtrs = 14 0130N 0100W 003, 14 0130N 0100W 004, 14 0130N 0100W 009, 14 0130N 0100W 999

Commodity =

Commodity Txt =

Pending Org =

Pend Org Decode =

Total Rows Returned: 2

RUN TIME: 02:40 PM

UNITED STATES DEPARTMENT OF INTERIOR  
BUREAU OF LAND MANAGEMENT  
GEOGRAPHIC REPORT WITH LAND  
Sorted by Serial Number

RUN DATE: 11/18/2016  
Page 1 of 1

Serial Number: AZA 012037

Total Case Acres: 2,231.010

<u>Casetype</u>	<u>Case Disp</u>	14	0130N	0100W	<u>Sect</u>	<u>Sur Typ</u>	<u>Sur Num</u>	<u>Suff</u>	<u>Subdivision</u>	<u>Act Pend</u>
285007	AUTHORIZED				009	ALIQ			S2SW;	

Serial Number: AZAR 0035584

Total Case Acres: 0.100

<u>Casetype</u>	<u>Case Disp</u>	14	0130N	0100W	<u>Sect</u>	<u>Sur Typ</u>	<u>Sur Num</u>	<u>Suff</u>	<u>Subdivision</u>	<u>Act Pend</u>
285004	AUTHORIZED				009	ALIQ			SWSW;	

TOWNSHIP 13 NORTH RANGE 10 WEST OF THE GILA AND SALT RIVER MERIDIAN, ARIZONA

MOHAVE / YAVAPAI COUNTY  
KINGMAN FIELD OFFICE

STATUS OF PUBLIC DOMAIN  
LAND AND MINERAL TITLES

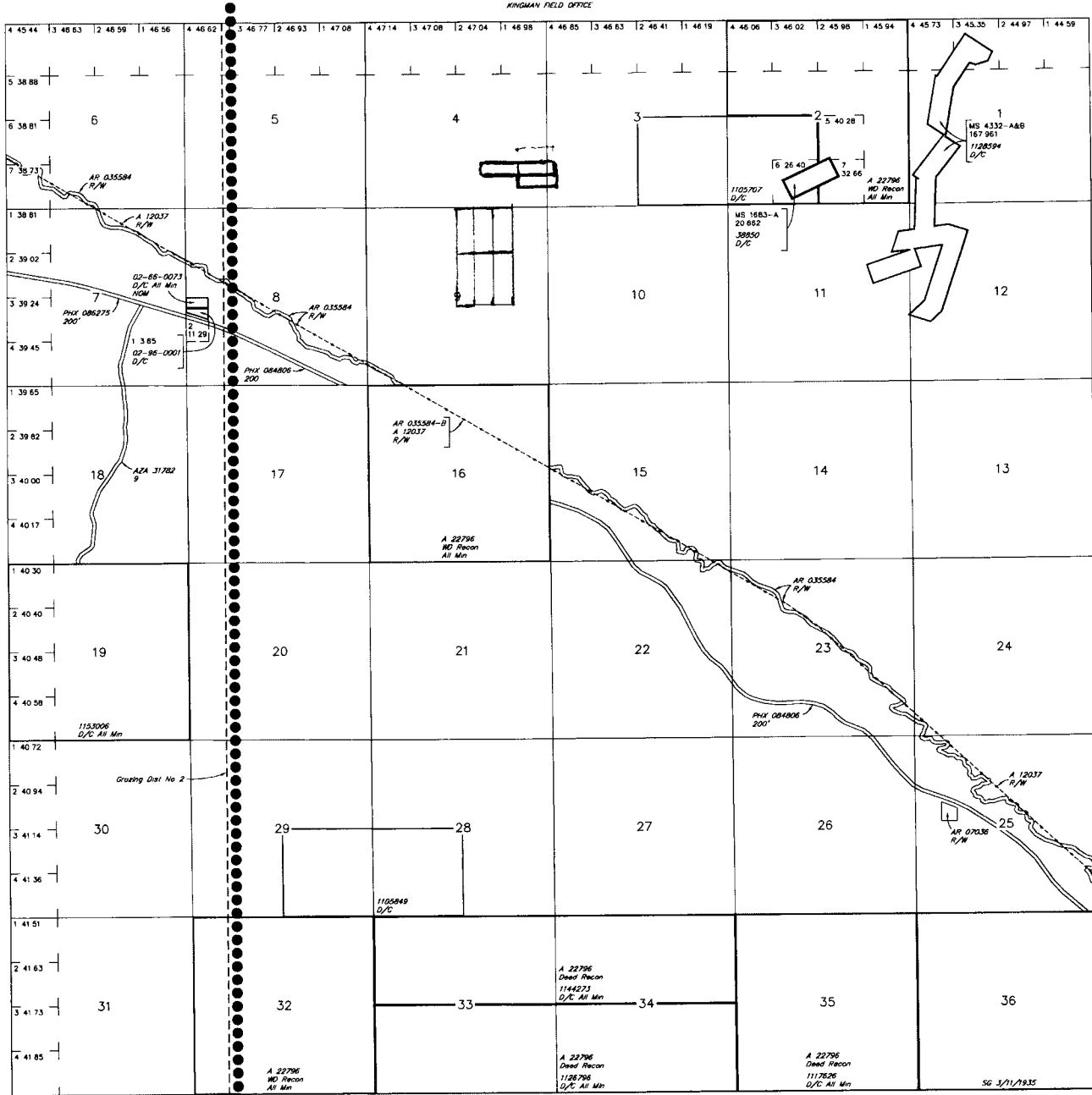

RESURVEY TRACT NO	ORIGINAL SURVEY	
	T	R SEC SUBDIVISION

FOR ORDERS AFFECTING DISPOSAL OR USE OF UNIDENTIFIED LANDS WITHDRAWN FOR CLASSIFICATION, MINERALS, WATER AND/OR OTHER PUBLIC PURPOSES, REFER TO INDEX OF MISCELLANEOUS DOCUMENTS

- MDS J45 NE
- AZA 26411-CC R/W Highway  
 Sec 7 S1/2N1/2, N1/2SE1/4  
 Sec 8 Lots 1, 2, E1/2SW1/4, E1/2NW1/4SW1/4, S1/2SE1/4  
 Sec 15 SW1/4, SW1/4SE1/4  
 Sec 16 S1/2NE1/4, NW1/4, N1/2SE1/4  
 Sec 17 NE1/4NE1/4  
 Sec 22 NE1/4, NE1/4NW1/4, NE1/4SE1/4  
 Sec 23 NW1/4SW1/4, S1/2S1/2  
 Sec 26 N1/2NE1/4
- AZA 26411-EE R/W Highway  
 Sec 25 NW1/4NW1/4, S1/2NW1/4, NE1/4SW1/4, SE1/4  
 Sec 26 NE1/4NE1/4

R 11W R 10W MOHAVE 015 YAVAPAI 025  
T 12N

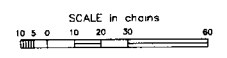

WARNING STATEMENT  
 This plot is the Bureau's Record of Title, and should be used only as a graphic display of the township survey data. Records herein do not reflect title changes which may have been effected by lateral movements of rivers or other bodies of water. Refer to the cadastral surveys for official survey information.

Lot 34 25'00"N  
Long 113 15'00"W

CURRENT TO	NW	GSR Mer
7-30-2012	ACAD	T 13 N
		R 10 W

P.O. Box 1507  
Congress, Az  
85332



Bureau of Land Management  
One N. Central Ave Box 55  
Phoenix, Az 85004

RECEIVED  
BLM AZ STATE OFFICE  
2016 NOV 15 P 1:48  
PHOENIX, ARIZONA